

Plans are not to scale. Field is slightly rolling pasture land. Course Plans may be altered due to weather or other conditions. Drag or Continuous Lure machine with white plastic lures will be used. Backup machine is available.

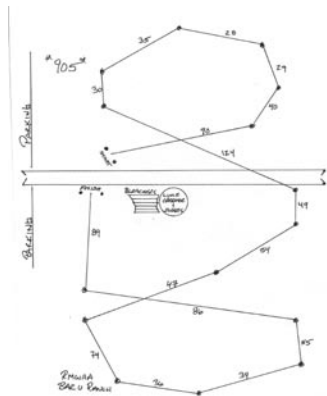

SAT

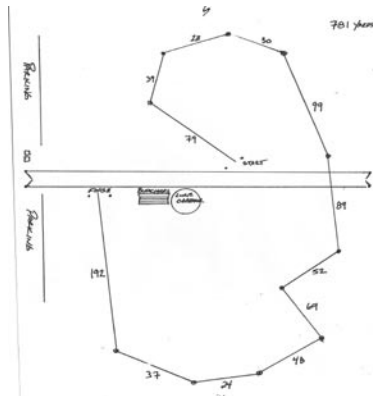

SUN

Additional Information

- Overnight parking permitted on field. **Please park in the designated area.** Port-a-potty on site.
- Stakes will be split if the entry is 24 or more hounds at roll call.
- Hounds will be run twice, in braces or trios (except single dog entries) unless excused, dismissed, or declared ineligible.
- Lamé hounds or bitches in season will be excused and their entry refunded, provided notice is given prior to or during roll call.
- Hounds not present at roll call shall be scratched with no refunds. **No Exceptions.**
- All handlers must use a slip lead when releasing a hound. A **Standing Start** will be used on Tally-Ho.
- Leg wrappings must be of a neutral colour to comply with CKC rules. Muzzles & catch collars may be used at the handler's discretion. **No Flexi-leads or shock collars allowed.**
- A \$10.00 fine will be assessed for loose dogs on the field after roll call and until after Best in Field.
- Bring your own water and shade.
- No catalogue will be published. Score sheets will be available.
- A veterinary clinic is within easy access to the field.
- **Please clean up after yourselves and your dogs. Do not stuff plastic bags down holes. Please use the trash receptacles provided.**



OFFICIAL PREMIUM LIST
Pre-entries for Coursing Only: June 13, 2018
Post-entries close 1/2 hour prior to Roll Call

2 CKC Lure Coursing Field Trials
June 16th & 17th, 2018

Note: Rolling Roll Call from when you arrive until 9:00 AM

This is an outdoor event

Bar U Ranch
Longview, Alberta

THERE WILL BE NO CONCESSION ON SITE
Bar U Ranch has a restaurant in visitor center 10 am-5 pm

Judges:

Edward L Molloy – 169 52061 Range Rd 215, Sherwood Park, AB T8E 1B2
Debra Verzyl – 11081 North Watts Rd, Ladysmith BC V9G 1Y6
Karen M Douglass – PO Box 12, Site 9, RR 3, Ponoka AB T4J 1R3

TRIAL SECRETARY: To whom all entries must be sent

Wendy Rossetti
PO Box 49
Stirling, AB T0K 2E0
(403) 756-3998
Email: weerob@gmail.com

WE ARE UNABLE TO ACCEPT FAX OR CREDIT CARD ENTRIES
These events held under rules of the Canadian Kennel Club
ONLY in the event of a Postal Strike will phone entries be accepted

EMAIL ENTRIES WILL BE ACCEPTED IF ACCOMPANIED BY AN E-TRANSFER PAYMENT. Both are to be sent to the trial secretary: weerob@gmail.com

Rocky Mountain Whippet Association of Alberta

President Robert Rossetti
Vice President Ursula Webber
Secretary Wendy Rossetti
Treasurer Wendy Rossetti

Field Trial Secretary Wendy Rossetti

Veterinarian Accessible to grounds

Canadian Kennel Club Officials

CKC Head Office Lance Novak, Executive Director
200 Ronson Drive, Suite 400
Etobicoke, ON
M9W 5Z9

AB Lure Coursing Rep Edward L Molloy
169 52061 Range Rd 215,
Sherwood Park, AB T8E 1B2

AB Director Sharon Derrick
60 Riverview Cl SE, Calgary, AB T2P 2G9

Eligible Entries:

Open to any Afghan, Basenji, Borzoi, Greyhound, Ibizan, Italian Greyhound, Pharaoh Hound, Saluki, Scottish Deerhound, Whippet, Irish Wolfhound or CKC Miscellaneous Sighthound that is one year or older the day of the trial. All entrants must be registered or eligible for registration, with the Canadian Kennel Club, have ERN # or PEN #. Hounds presently disqualified under CKC, ASFA, CSFA OR AKC rules cannot compete. Hounds with breed standard disqualifications, or altered/neutered are eligible to enter the lure field trial. **Hounds must pre-qualify prior to entering their first trial in Canada. See information elsewhere in this Premium List.**

Entry Fees:

Pre-Entry: (up to June 13, 2018) Includes CKC Recording Fee

\$22.00 1st hound per trial

\$20.00 2nd and subsequent hound per trial

Post-Entry: (after June 13, 2018) Includes CKC Recording Fee

\$30.00 per hound per trial

Other Fees:

\$15.00 Singles Competition **See description**

\$5.00 per entry/stake - All unofficial classes

\$10.00 listing fee for all non-CKC registered hounds (includes 5% GST)

\$50.00 fee if cheque returned.

Make cheques payable to Rocky Mountain Whippet Association of Alberta (RMWAA)

Any overpayment of entries fees is considered a trophy donation

No Credit Cards or Postdated Cheques will be accepted

Directions to the Field:

Bar U Ranch National Historic Site is located approximately 95 km (59 miles) south of Calgary on Highway 22, 13 km (8 miles) south of Longview. From Calgary, go south on Highway 2, then west on Highway 540, cross over Highway 22 (also known as The Cowboy Trail) and continue west for approximately half a kilometer

Distances From Bar U to:

High River 45 km

Okotoks 55 km

Calgary 95 km



JUDGES ASSIGNMENTS:

Edward Molloy – All breeds except Greyhounds Saturday & Sunday

Debra Verzyl – All breeds except Basenji Saturday & Sunday

Karen Douglass – Basenji & Greyhounds Saturday & Sunday

Roll Call and Running Order

We are offering a Rolling inspection between the time you arrive and Roll Call.

Official Classes: Post Entry: closes at 8:30 am. Roll Call at 9:00 a.m.

Singles (Saturday): Post Entry: closes at 9:00 am.

Puppies & Veterans (Saturday): Post Entry: closes at 9:00 am.

Breed running order will be posted at Roll Call.

Singles (Saturday) – Immediately following preliminary courses.

Puppy & Veterans (Saturday) – Immediately following preliminary courses.

Best in Field will be run both days.

Handlers Meeting will be held after roll call & before test dog.

FIELD COMMITTEE

CHAIRMAN: Robert Rossetti

SECRETARY: Wendy Rossetti

COMMITTEE: Wendy Rossetti, Robert Rossetti, Richard Kurpershoek

HUNT MASTER: Robert Rossetti

LURE OPERATOR: Richard Kurpershoek, Dave Armstrong

FIELD CLERK: Ivy Molloy, Miriam Woestenburg,

Stakes Offered

- **Open Stakes** For all hounds including Field Champions
- **Veteran Competitive** For all hounds over 7 years of age including Field Champions
- **Mixed Stakes** Combines breeds with entries of three or less with agreement of all owners.
- **Veteran Mixed Stake** Combines breeds with entries of three or less with agreement of all owners.
- **Best in Field** For all Best of Breed winners & 1st from Mixed
- **Singles** See Description elsewhere (*Saturday Only*)
- **Puppy Sweeps** Puppies between 6 & 18 months are run **individually** (*Saturday Only*)
- **Veteran Sweeps** Dogs 7 years & older on date of trial. Run individually. (*Saturday Only*)
- **Breeder Stake** Open to any 2 hounds in the official classes bred by the same person(s). (*Saturday Only*)
- **Kennel Stake** Open to any 2 hounds in the official classes owned & kenneled by the same person(s). (*Sunday Only*)
- **Club Stake** Open to any 2 hounds in the official classes owned by club members (*Saturday Only*)

*NOTE: Breeder, Kennel stakes & Club Stakes combinations **MUST** be declared prior to Roll Call.

Placements and Awards

Chapter 7, Section 1: Championship points are awarded in regular stakes only on the following basis:

1st: 4 x # of hounds competing in stake, to a max. of 40 points

2nd: 3 x # of hounds competing in stake, to a max. of 30 points

3rd: 2 x # of hounds competing in stake, to a max. of 20 points

4th: 1 x # of hounds competing in stake, to a max. of 10 points

NBQ: No points

No hound shall receive a placement or points if it does not score at least 50% of the total possible combined scores. If a hound has been **excused** in the preliminary run, that hound shall not count as having been in competition. **Exhibitors please note:** As per rule 9.6.1(b) of the CKC Lure Field Trial Rules and Regulations a dog must "Attain 1 first or 2 second placements by **defeating dogs in head to head competition**". No placements will be awarded towards CKC championships if all dogs in a breed run as singles, but the points will stand.

SINGLES COMPETITION

9:00 AM Roll Call - If your dog is DQ'd or not ready for running in competition, but you would like your dog judged? This is the place to be! Run individually, over the entire course (both directions) the dog is judged by two judges. No points are awarded and all ties are settled by a coin toss. A trophy and ribbon will be awarded to 1st place and ribbons for 2nd to NBQ.

Prize List

Best of Breed (or 1st if stake is split or 1st in Mixed Stake) Rosette + Suitable Prize

2nd to NBQ - Rosette only

Best in Field - Rosette + Suitable Prize

Singles - Rosette + Suitable Prize for 1st place.

All placements receive a ribbon.

Puppy and Veteran

All placements receive a ribbon. Best Overall Rosette & Prize

Unofficial Stakes-Ribbon

Special Prize List

- Landra Wowchuck Grantham is offering a prize for **Best of Breed Afghan Sat & Sun.**
- Richard & Shari Kurpershoek are offering a prize for **High Aggregate Whippet over the weekend**
- Lenna & Rob Maxwell are offering a prize for **High Scoring First time entered Whippet**

| |
|--|
| <p>RMWAA wants YOU!! Help keep our trials running smoothly. Volunteer at Roll Call to judge our Puppy and Veteran runs, that way we don't have to beg for judges before the runs start.</p> |
|--|

First Time Entered Hounds: (This does not apply to Singles Competition)

Effective July 1 1998, hounds entering their first trial in Canada must be tested with another hound, **not** a kennel mate, and certified running clean by a licensed judge. The CKC Hound Certification Form must be completed and **submitted with the entry at the hound's first trial.** Hounds with the following titles are exempt: ASFA FCh or VFCh, AKC FC or SC, but are still required submitting the Hound Certification Form with their name and exempting titles circled.

All prizes must be claimed at the trial. They will NOT be mailed.

ATTENTION ALL FOREIGN EXHIBITORS

Effective January 1, 1992 all dogs that are foreign born and foreign owned and enter Canada for the sole purpose of entering CKC events will no longer require a CKC registration number but will require an **Event Registration Number (ERN)**. This ERN does not register a dog for breeding purposes as defined in the Animal Pedigree Act, but rather enables a foreign-owned dog to be awarded titles by the Canadian Kennel Club. Each dog must have its own number. To obtain an ERN, mail or fax a photocopy of the dog's foreign registration certificate with cheque or VISA/MasterCard number (expiry date, cardholder's name and signature). Provide your complete address for return of the ERN to you. Cost is \$56.70. ERN MUST BE APPLIED FOR WITHIN 30 DAYS OF FIRST DAY OF ENTERING A CKC EVENT TO AVOID CANCELLATION OF AWARDS.

CKC FAX number: (416) 675-6506

Current exchange rates favor the US dollar. To take advantage of this, please purchase bank drafts or money orders payable in Canadian funds. We will accept personal cheques, however they must be payable in US funds for the full amount of the entry. Cheques marked "payable in Canadian funds" will **not** be accepted.

Non Member Participation Fee

The following non-member participation fee now applies and is retroactive to January 1, 2011. The non-member participation fee applies to all Canadian residents who participate in a CKC event but are not CKC members and a participating non-member can chose to purchase a CKC membership or pay the non-member fee. This only applies to dogs wholly owned by non members and is not applicable to CKC members or dogs co-owned with a CKC member. In order for the CKC to efficiently manage recording and tracking points, it's important that non-members select one of the two options within 30 days of notification or, unfortunately, CKC will be forced to cancel any awards and titles

Non-Member Participation Fee

24-12-3. Non-member participation fee

- An **annual** non-member participation fee for awards and titles will be charged to a Canadian non-member of CKC. The fee will match the ERN fee.
- In order to protect the awards/titles earned, the non-member will have a choice either to become a CKC member or to pay the non-member participation fee. Failure to comply within 30 days of notification will cause all awards and titles to be cancelled.
- The Premium List must carry a note stating that "these fees apply only to dogs wholly owned by non-CKC members and are not applicable to CKC members."

For more information about either the Non-Member Participation Fee or becoming a CKC member please go to the CKC website www.ckc.ca



CANADIAN KENNEL CLUB

200 RONSON DRIVE, SUITE 400, ETOBICOKE, ONTARIO, M9W 5Z9 TEL: (416) 675-5511 FAX: (416) 675-6505
WEBSITE: www.ckc.ca

CLUB CANIN CANADIEN

HOUND CERTIFICATION

A hound must be tested with another dog of the same breed or a breed with a similar running style (preferably not a kennel mate), and certified running clean by a licensed judge.

Hounds must be a minimum of 11 months old prior to being certified, and must run a course of 600 yards (548.4m) in order to be certified. Please complete the bottom half of this form and attach it to the entry form for the hound's first entry in a trial. (see Section 7.1.1)

Registered Name of Hound: _____

CKC Reg #: _____ Breed: _____

Registered Owner's Name: _____

I hereby certify that on (date) _____ the above named hound completed a lure course of at least 600 (548.4 m) yards running with another hound of the same breed (or another breed with a similar running style). During the course the above named hound showed no inclination to interfere with the other hound. I further certify that I am a regularly licensed judge.

Name of Licensed Judge _____

Signature: _____ Date _____

I hereby certify that the hound run in the certification course is the hound identified above and that the information on this form is correct.

Signature: _____ Date _____

Owner or authorized Agent of hound

Waiver of Requirement: This requirement will be waived for a hound that has earned a lure coursing title from another recognized organization if such title required competition, and if a waiver for such title has been approved by the Canadian Kennel Club. If your to your entry form. AKC Titles:

This certification form must be attached to the entry form the first time this hound is entered. Any hound entered in open which has not been certified shall be declared ineligible and shall forfeit any points and placements awarded.

PLEASE RETAIN A COPY FOR YOUR RECORDS

AKC Titles: FC SC ASFA Titles: FCh VFCh

This certification form must be attached to the entry form the first time this hound is entered. Any hound entered in open which has not been certified shall be declared ineligible and shall forfeit any points and placements awarded.

RMWAA Waiver

Please include this signed document with your entry form.

I (we) agree that the Club holding this event has the right to refuse this entry for cause which the organizing committee shall deem to be sufficient.

In consideration of the acceptance of this entry, the holding of this event and the opportunity to have the dog judged, I (we) agree to hold the organizing committee, the organization which it represents, including its members, officers and directors, owners of the premises upon which the event is held and their employees, harmless from any claim for loss or injury which may be alleged to have been caused directly or indirectly to any person or thing by the act of this dog while in or upon the event premises, or grounds, or near any entrance thereto, and I (we) personally assume all responsibility and liability for any such claim.

I (we) further agree to hold the aforementioned parties harmless from any claim for loss of this dog by disappearance, theft, death, or otherwise, and from any claim for damage or injury, to be caused or alleged to be caused by negligence of the parties aforementioned, or by the negligence of any other person, or any other cause or causes.

I (we) hereby assume the sole responsibility for and agree to indemnify the aforementioned parties harmless from any and all loss and expenses (including legal fees) by reason of the li aforementioned parties for damage because of bodily injuries, including death at any time resulting there from sustained by any person or persons, including
Myself (ourselves) or on account of damage to property, arising out of or in consequence of my (our) participation in this event, howsoever such injuries, death or damage to property may be caused or may have alleged to have been caused by negligence of the aforementioned parties or any of their employees or agents, or any other person.

Signature of Owner, Agent, Handler:

_____ **Date:** _____
Signature of parent/guardian is required for children under 18 years



OFFICIAL CANADIAN KENNEL CLUB FORM

LURE COURSING

**ROCKY MOUNTAIN WHIPPET
ASSOCIATION OF ALBERTA**

Saturday Sunday

I Enclose \$_____ for Entry Fees \$_____ Listing Fees \$_____

PLEASE TYPE OR PRINT CLEARLY

| | | |
|--|--|---------------|
| Breed: | Call Name: | Sex: |
| Enter in the following Stakes: _____ OPEN _____ SINGLE _____ PUPPY _____ VETERAN | | |
| Please separate my entries <input type="checkbox"/> Hound's first trial? <input type="checkbox"/> (attach Certification Form) | | |
| Registered | | |
| Name of Dog: | | |
| Check one and enter number here | | |
| <input type="checkbox"/> CKC Reg. No. | Date of Birth | |
| <input type="checkbox"/> CKC ERN or PEN No. | D____M____Y____ | |
| <input type="checkbox"/> CKC Misc. Cert. No. | Place of Birth | |
| <input type="checkbox"/> Listed | Canada <input type="checkbox"/> Elsewhere <input type="checkbox"/> | |
| <input type="checkbox"/> Foreign No. & Country | | |
| Breeder(s) | | |
| Sire | | |
| Dam | | |
| Reg'd Owner(s) | | |
| Owner's Address | | |
| City | Prov | PC |
| Name of Owner's Agent (if any) at the Trial | | |
| Agent's Address | | |
| City | Prov | PC |
| Owner's CKC Membership No. _____ | | |
| I certify that I am the Registered owner(s) of the dog or that I am the authorized agent of the owner(s) whose name(s) I have entered above and accept full responsibility for all statements made in this entry. In consideration of the acceptance of this entry, I (we) agree to be bound by the rules and regulations of the Canadian Kennel Club and by any additional rules and regulations in the premium list. | | |
| | | |
| SIGNATURE OF OWNER OR AGENT | | TELEPHONE NO. |
| E-MAIL ADDRESS: | | |



OFFICIAL CANADIAN KENNEL CLUB FORM



LURE COURSING

**ROCKY MOUNTAIN WHIPPET
ASSOCIATION OF ALBERTA**

Saturday Sunday

I Enclose \$_____ for Entry Fees \$_____ Listing Fees \$_____

PLEASE TYPE OR PRINT CLEARLY

Breed: _____ Call Name: _____ Sex: _____

Enter in the following Stakes: _____ OPEN _____ SINGLE _____ PUPPY _____ VETERAN

Please separate my entries Hound's first trial? (attach Certification Form)

Registered
Name of Dog: _____

Check one and enter number here
 CKC Reg. No. _____ Date of Birth _____
 CKC ERN or PEN No. _____ D____M____Y____
 CKC Misc. Cert. No. _____ Place of Birth _____
 Listed _____ Canada Elsewhere
 Foreign No. & Country _____

Breeder(s) _____

Sire _____

Dam _____

Reg'd Owner(s) _____

Owner's Address _____

City _____ Prov _____ PC _____

Name of Owner's Agent (if any) at the Trial _____

Agent's Address _____

City _____ Prov _____ PC _____

Owner's CKC Membership No. _____

I certify that I am the Registered owner(s) of the dog or that I am the authorized agent of the owner(s) whose name(s) I have entered above and accept full responsibility for all statements made in this entry. In consideration of the acceptance of this entry, I (we) agree to be bound by the rules and regulations of the Canadian Kennel Club and by any additional rules and regulations in the premium list.

SIGNATURE OF OWNER OR AGENT

TELEPHONE NO.

E-MAIL ADDRESS:



OFFICIAL CANADIAN KENNEL CLUB FORM



LURE COURSING

**ROCKY MOUNTAIN WHIPPET
ASSOCIATION OF ALBERTA**

Saturday Sunday

I Enclose \$_____ for Entry Fees \$_____ Listing Fees \$_____

PLEASE TYPE OR PRINT CLEARLY

Breed: _____ Call Name: _____ Sex: _____

Enter in the following Stakes: _____ OPEN _____ SINGLE _____ PUPPY _____ VETERAN

Please separate my entries Hound's first trial? (attach Certification Form)

Registered
Name of Dog: _____

Check one and enter number here
 CKC Reg. No. _____ Date of Birth _____
 CKC ERN or PEN No. _____ D____M____Y____
 CKC Misc. Cert. No. _____ Place of Birth _____
 Listed _____ Canada Elsewhere
 Foreign No. & Country _____

Breeder(s) _____

Sire _____

Dam _____

Reg'd Owner(s) _____

Owner's Address _____

City _____ Prov _____ PC _____

Name of Owner's Agent (if any) at the Trial _____

Agent's Address _____

City _____ Prov _____ PC _____

Owner's CKC Membership No. _____

I certify that I am the Registered owner(s) of the dog or that I am the authorized agent of the owner(s) whose name(s) I have entered above and accept full responsibility for all statements made in this entry. In consideration of the acceptance of this entry, I (we) agree to be bound by the rules and regulations of the Canadian Kennel Club and by any additional rules and regulations in the premium list.

SIGNATURE OF OWNER OR AGENT

TELEPHONE NO.

E-MAIL ADDRESS:

Hotels Available in the area:

Ramada High River Inn & Suites
1512-13th Avenue SE
High River, Alberta
403 603-3183

Heritage Inn Hotel & Convention Centre
1104 11 Ave SE
High River, Alberta
403 652-3834
1-888-888-4374

Super 8 High River
1601 13 Ave
Highway 2 exit Highway 23
High River, Alberta
403 652-4445
1-866-831-8555

Okotoks Hotels

Best Western Plus Okotoks Inn & Suites
100 Southbank Road
Okotoks, Alberta
403 995-6262

Lakeview Inn & Suites
22 Southridge Drive
Okotoks, Alberta
403 938-7400 -
1 977-355-3500