

Official Premium List

Stormont, Dundas, & Glengarry Dog Association

Entries Close:

TUESDAY, JULY 31, 2012

AT 8 p.m.

Eukanuba 

Friday, Saturday, Sunday, Monday

August 24, 25, 26, 27, 2012

110th, 111th, 112th, 113th

4 All Breed Championship Shows

119th, 120th, 121st, 122nd, 123rd, 124th

6 All Breed Obedience Trials (LIMITED ENTRY)

23rd, 24th, 25th, 26th, 27th, 28th

6 All Breed Rally Trials (LIMITED ENTRY)

Long Sault Campgrounds, Woodlands Campsite, Long Sault, ON. Canada

<http://www.stlawrenceparks.com/lsp.htm>

These Shows held under the rules of The Canadian Kennel Club (CKC) - This event held *Outdoors* - Unbenched & Unexamined

“no cover will be provided in case of inclement weather”

All Breed Brace – Sunday August 26, 2012 – ONLY

(16) SPECIALTIES

Saturday, August 25, 2012

Club Barbet Canada	Canadian Bloodhound Club
Ottawa Valley All Setter Association	Dalmatian Club of Canada
Pointer Club of Canada – National	
German Shorthaired Pointer Club of Canada	Rideau Terrier Club - Group 4 Specialty
Standard Schnauzer Club of Canada	Norfolk Terrier Club of Canada – National
Nova Scotia Duck Tolling Retriever Club of Canada - Regional	
Vizsla Canada	

Sunday, August 26, 2012

Border Terrier Club of Ontario
English Springer Spaniel Club of Canada - National
Ottawa Valley **Pointing Dog** Club
Specialty for **Miniature Schnauzer** Only - Rideau **Terrier** Club
Wire Fox Terrier Club of Canada - National

62 – BOOSTERS

Boosters for – ALL TERRIERS, Barbet, Bloodhound, Dalmatian, ALL POINTERS, Braque Français, Kleiner Munsterlander Vorstehund, Wire-Haired Pointing Griffon, Pointer, Pointer (GLH, GSH, GWH), Pudelpointer, Spaniel (Blue Picardy, Brittany, French), Spinone Italiano, Weimaraner, Setters (English, Gordon, Irish and Irish Red & White), Vizsla (SM & WH), Schnauzer (Standard), Spaniel (English Springer)

Junior Handling - SD & G - Conformation - Sunday August 26, 2012

To comply with instructions issued by the CKC we will be unable to accept, cancel, or substitute any entry reaching our show secretary after the official closing date. **ENTER ONLINE AT www.colmars.com**

S stormont
D undas
&
G lengarry
Long Sault
ON



Stormont, Dundas, & Glengarry Dog Association - Officers

(At time of Publication)

President.....Rachelle O'Meara
Secretary.....Sandra Cummings
Directors:.....Jodie O'Meara

Vice-PresidentCandy Beauchamp
TreasurerConnie Charlebois

Show Committee (At time of Publication)

Show Superintendent Jodie O'Meara, (613) 443-2262, banquise@sympatico.ca
Co - Show Superintendent.... Kristy Tedford Show Chairperson:Jodie O'Meara
Chief Ring Steward Candy Beauchamp Booth Rental Jeff Dale, jdale@trademarkmedia.ca
RV & Trailer Parking - Jeff Dale, 613-366-2030 ext# 2000 jdale@trademarkmedia.ca

Show Photographer - Dean Dennis Photography, PO Box 123, Arden, ON 613-335-4386
EMAIL: dean@deandennisphotography.ca

No pictures may be taken for the purpose of resale at the SD & G dog show by anyone other than the official show photographer(s) without express written consent from the SD & G club.

Veterinarian – St. Lawrence Valley Animal Hospital, 435 Pitt St., Cornwall, ON (613) 932-4094
Show Secretary - **COLMAR Show Service, In Canada:** 340 Mercer St., Chatham, ON, Canada N7M 6E1
In USA: PO Box 142, Marine City, MI, USA 48039-0142
Phone: (519) 351-3147 Email: colmar@ciaccess.com website: www.colmars.com

Canadian Kennel Club

(at time of publishing)

Head Office: Nancy Carey, Executive Director, 400 – 200 Ronson Dr., Etobicoke, ON. M9W 5Z9. (416) 675-5511

Eastern Ontario CKC Director Zone 5 – Bob Rowbotham,

505 Airport Rd., RR # 4, Stirling, ON K0K 3E0 – bob@rock107.ca

Conformation Rep.....Robert Whitney,

313 Pipeline Rd RR#2, Castleton, ON, K0K 1M0 rwhitney@xplornet.com

Obedience Rep.....Frances Holmes

112 Grey Stone Dr., Carp, ON KOA 1L0 frances@thetraininghall.com

Junior Handling Rep.....Kim Groves,

10 Grimes St., Brighton, ON K0K 1H0 avatarbmd@sympatico.ca

Have More Than Ten Dogs? - Exhibitors /Handlers with 10 or more dogs contact - Jeff Dale,
613-366-2030 ext# 2000 jdale@trademarkmedia.ca - for any help in your stay.

Catalogue Advertising

Bus Card or Quarter Page \$20.00 - Half Page \$ 30.00 - Full Page \$ 60.00 - Send camera ready materials
along with a cheque payable to Stormont, Dundas, & Glengarry Dog Association by August 4, 2011,
to: COLMAR Show Service, 340 Mercer St., Chatham, ON. N7M 6E1

Booth Space - Jeff Dale, 613-366-2030 ext# 2000 jdale@trademarkmedia.ca

All Booth Space is on a First Come First Serve Basis

10 x 10 - \$ 245.00, 10 x 20 - \$ 280.00, 10 x 30 or 20 x 20 - \$ 315 per day

Electrical \$ 40.00 extra, includes 1 Table included

We welcome all exhibitors and spectators, including persons with disabilities. If you require accommodation of a disability, please make your accommodation known to the club in advance. Please contact the Superintendent by the closing date to ensure that we can do our best to accommodate your needs.

Note: Overflow camping hydro (electric) is \$50.00 and

MUST to be pre paid by August 16, 2012

Please forward payment to; Jodie O'Meara,

6135 Garlandside Rd., Cumberland, ON K4B 1S7

For more information contact - Jeff Dale, jdale@trademarkmedia.ca

FUN MATCH - Friday August 24, 2012 after Best in Show

For more information: Myriam Ruel, 4515 chemin Clement-Pesant, Mirabel, QC J7N2Y9
Myriam.Ruel@aero.bombardier.com or Diane Dandurand at : danandre@videotron.ca

Judges - SD & G - Conformation

- Dr. Francisco Chapa**4a Vidriera 1505 Ote ,Col Cantu,Monterrey, N.L., **MEXICO** 64550
Douglas Holloway 2131 Pleasant Valley Rd., Newark, DE **USA** 19702-2103
Rita Holloway 2131 Pleasant Valley Rd., Newark, DE **USA** 19702-2103
Conny Gutierrez-Otero..... San Marcos 11 Edif. Delfos 301, Mexico City, **MEXICO** 10720
Peggy Gutierrez-Otero..... Progreso 21-1, San Nicolas, Mexico DF, **MEXICO** 10900
Mrs. Robert (Polly) D. Smith.... PO BOX 309, St Stephens Church, VA **USA** 23148-0309
Dr. Robert Smith PO BOX 309, St Stephens Church, VA **USA** 23148-0309
Betty - Anne Stenmark 12970 Skyline Blvd., Woodside, CA **USA** 94062-4559

Judging Assignments – Conformation * Denotes Group Judge

Group	Friday August 24, 2012	Saturday August 25, 2012	Sunday August 26, 2012	Monday August 27, 2012
1	Setter (English) Setter (Gordon) Setter (Irish) Setter (Irish Red & White) Francisco Chapa Balance of Breeds Mrs. R. (Polly) Smith*	Pointer (GSH) Retriever (Golden) Retriever (Labrador) Setter (Irish) Spaniel (English Cocker) Spaniel (English Springer) Vizsla (Smooth Haired) Vizsla (Wire Haired) Weimaraner Douglas Holloway Balance of Breeds Dr. Robert Smith *	Pointer (GSH) Retriever (Golden) Retriever (Labrador) Setter (Irish) Spaniel (English Cocker) Spaniel (English Springer) Vizsla (Smooth Haired) Vizsla (Wire Haired) Weimaraner Dr. Robert Smith Balance of Breeds P. Gutierrez-Otero *	C. Gutierrez-Otero *
2	B.A. Stenmark	P. Gutierrez-Otero *	C. Gutierrez-Otero *	Dr. Robert Smith *
3	Dr. Robert Smith *	Mrs. R. (Polly) Smith*	Douglas Holloway *	Francisco Chapa *
4	P. Gutierrez-Otero *	C. Gutierrez-Otero *	Dr. Robert Smith *	Mrs. R. (Polly) Smith*
5	C. Gutierrez-Otero *	P. Gutierrez-Otero *	Francisco Chapa *	Mrs. R. (Polly) Smith*
6	C. Gutierrez-Otero *	Francisco Chapa *	Rita Holloway *	P. Gutierrez-Otero *
7	Francisco Chapa *	C. Gutierrez-Otero *	Mrs. R. (Polly) Smith*	P. Gutierrez-Otero *
BIS BPIS	Mrs. R. (Polly) Smith	C. Gutierrez-Otero	Francisco Chapa & Best Brace	P. Gutierrez-Otero

**No show or event - Specialty, All Breed, Performance Event,
or Best in Show Judging, shall be delayed for any Exhibitor
who has a conflict in another ring or event.**

**All exhibitors are expected to have alternative
arrangements made for any possible conflict.**

SD & G ALL BREED AGILITY TRIALS - - AUGUST 24, 25, 26, 2012

Entries Open May 30, 2012 - Entries Close: Aug 9/12,
or when the limit of 300 runs per day has been met

Trial Secretary: Sharon Dunsmore

K-9 Klubhouse Training Centre, 738 Edgewood Rd. Pickering ON L1V 2Z6
905-837-2364 or Fax 905-837-0142 email: sharon@k9klubhouse.ca website: www.k9klubhouse.ca

Obedience & Rally Judges

Bruce Gibbons..... RR # 4, 869 River Rd., Kemptville, ON K0G 1J0

Diana E Mackenzie 119 Buckingham Dr., Hamilton, ON L9C 2G8

Gail Wormington..... 101 517 Donegani Ave., Pointe-Claire, QC H9R 2W8

OBEDIENCE (LIMITED ENTRY) –Assignments

Rally / Obedience entries limited to 420 minutes per day/per judge – Trials may close earlier

Class	Trial # 1 Aug 24, 2012	Trial # 2 Aug 24, 2012	Trial # 3 Aug 25, 2012	Trial # 4 Aug 25, 2012	Trial # 5 Aug 26, 2012	Trial # 6 Aug 26, 2012
All Classes	B. Gibbons	D. Mackenzie	D. Mackenzie	B. Gibbons	B. Gibbons	G.. Wormington

RALLY (LIMITED ENTRY) - Assignments

Class	Trial # 1 Aug 24, 2012	Trial # 2 Aug 24, 2012	Trial # 3 Aug 25, 2012	Trial # 4 Aug 25, 2012	Trial # 5 Aug 26, 2012	Trial # 6 Aug 26, 2012
All Classes	D. Mackenzie	B. Gibbons	B. Gibbons	D. Mackenzie	G.. Wormington	B. Gibbons

Rally / Obedience entries limited to 420 minutes per day/per judge – Trials may close earlier

US Obedience Exhibitors

Any dog holding an AKC - CD Title is not eligible for Novice A, but may enter Novice B.

Any dog holding an AKC - CDX Title is not eligible for Open A, but may enter Open B.

CLASSES – OBEDIENCE

The following Official CKC Classes will be provided:

Pre – Novice, Novice "A", & "B", "C", Intermediate Novice, Open "A", Open "B", and Utility A & B.

6.9 MOVING UP – OBEDIENCE CKC Rules And Regulations (Effective January 01, 2012)

6.9.1 A dog that is registered in the records of the CKC or has a PEN, and ERN, or a MCN and has fulfilled the requirements for a title in accordance with these rules but at the time of the closing of entries for the trial has not received confirmation of the title may be moved to the next level of competition providing the request is submitted to the trial secretary on the appropriate move-up form by the owner or handler a minimum of one hour before the opening of the first trial on that day, schedule permitting.

6.9.2 When one or more trials are held on the same day in the same venue, the request for moving the dog up must be made a minimum of one hour prior to the scheduled start of the trial for which the dog is being moved up to, schedule permitting.

6.9.3 In the case of limited entry trial, move ups are permitted and the club is exempt from Section 4.3.4.

6.9.5 If it is established by the CKC that a dog moved up to the next level has not completed the requirements for the lower level before moving up, then all qualifying ribbons and/or awards earned by the dog incorrectly entered shall be forfeited and cancelled by the CKC and the owner may be subject to disciplinary action.

6.9.6 In order for a dog to be eligible to move up, the dog must be individually registered in the CKC or have a Performance Event Number (PEN), an Event Registration Number (ERN) or a Miscellaneous Certification Number (MCN) before entries close. The addition of a CKC number after close of entries does not make the dog eligible and will result in referral to the Discipline Committee.

6.9.7 Exhibitors incorrectly entered in the "A" class are permitted to move the dog to the corresponding "B" class up to one hour before the start of the trial.

PERFORMANCE EVENT NUMBER (PEN)

Effective Jan 01, 2002, a Performance Event Number (PEN), allows an unregistrable dog of a CKC recognized breed to participate in those competitive events that are appropriate for the breed. Those events are as follows: Obedience, Tracking, Herding, Draft Dogs, Agility, Lure Coursing, Earthdog Tests, Hunt Tests, Working Certificate Tests, and Pointing Field Dog Tests. A Dog that is eligible for a PEN may not be entered as a listed dog. Dogs may only enter events after a PEN has been issued to that dog. This restriction shall also apply to dogs with ILP numbers. Unregistrable Dog means, a dog of a recognized CKC breed that cannot be registered because of unknown parentage or the unavailability of its registration papers.

OFFICIAL CANADIAN KENNEL CLUB FORM		SD&G - CONFORMATION		Armband #
<input type="checkbox"/> Friday, August 24, 2012		<input type="checkbox"/> Sunday, August 26, 2012		 
<input type="checkbox"/> Saturday, August 25, 2012		<input type="checkbox"/> Monday, August 27, 2012		
Obedience		Dates		Price List
<input type="checkbox"/> Trial 1	<input type="checkbox"/> Trial 2	Friday August 24, 2012		<input type="checkbox"/> Trial 1
<input type="checkbox"/> Trial 3	<input type="checkbox"/> Trial 4	Saturday, August 25, 2012		<input type="checkbox"/> Trial 2
<input type="checkbox"/> Trial 5	<input type="checkbox"/> Trial 6	Sunday, August 26, 2012		<input type="checkbox"/> Trial 3
				<input type="checkbox"/> Trial 4
				<input type="checkbox"/> Trial 5
				<input type="checkbox"/> Trial 6
<input type="checkbox"/> Pre Paid and Pre Ordered Catalogue \$ 10.00 CDN/USD				
Entries Close: Tuesday JULY 31, 2012 at 8 pm				
Please Make ALL Cheques For Payable to SD & G Dog Association				
TOTAL FEES FOR THIS ENTRY: \$				
Conformation		Rally (Limited Entry)		Obedience (Limited Entry)
<input type="checkbox"/> Jr. Puppy (6 – 9 mth)		<input type="checkbox"/> Open		<input type="checkbox"/> Pre - Novice
<input type="checkbox"/> Sr. Puppy (9 – 12 mth)		<input type="checkbox"/> Specials Only		<input type="checkbox"/> Open A
<input type="checkbox"/> 12 – 18 month		<input type="checkbox"/> 6" <input type="checkbox"/> 8" <input type="checkbox"/> 12" <input type="checkbox"/> 16"		<input type="checkbox"/> Utility A
<input type="checkbox"/> Canadian Bred		<input type="checkbox"/> Novice A		<input type="checkbox"/> Novice A
<input type="checkbox"/> Brace (Sun Only)		<input type="checkbox"/> Novice B		<input type="checkbox"/> Open B
<input type="checkbox"/> Bred By Exhibitor		<input type="checkbox"/> Advanced A		<input type="checkbox"/> Utility B
<input type="checkbox"/> Exhibition		<input type="checkbox"/> Advanced B		<input type="checkbox"/> Exhibition
		<input type="checkbox"/> Excellent A		<input type="checkbox"/> Novice C
		<input type="checkbox"/> Excellent B		<input type="checkbox"/> Intermediate Novice
				Jump Heights
				Height
				Width
BREED				SEX: <input type="checkbox"/> MALE OR <input type="checkbox"/> FEMALE
REGISTERED				
NAME OF DOG				
Check One & Enter Number Here		Date Of Birth: Please Circle Month		IS THIS A PUPPY?
<input type="checkbox"/> CKC Reg #		Jan Feb Mar Apr May June		<input type="checkbox"/> Yes or <input type="checkbox"/> No
<input type="checkbox"/> CKC PEN #		July Aug Sept Oct Nov Dec		PLACE OF BIRTH?
<input type="checkbox"/> CKC ERN #		Day _____ Year _____.		<input type="checkbox"/> Canada
<input type="checkbox"/> CKC Misc Cert.#				<input type="checkbox"/> Elsewhere
<input type="checkbox"/> LISTED				
BREEDER(S)				
SIRE				
DAM				
REGISTERED OWNER(S)				
OWNER'S ADDRESS				
CITY	PROV/STATE	POSTAL CODE/ZIP		
NAME OF OWNERS AGENT (IF ANY) AT THE SHOW				
AGENT'S ADDRESS				
CITY	PROV/STATE	POSTAL CODE/ZIP		
Mail ID to: <input type="checkbox"/> OWNER Or <input type="checkbox"/> AGENT				
I certify that I am the registered Owner(s) of the dog or that I am the authorized agent of the Owner(s) whose name(s) I have entered above and accept full responsibility for all statements made in this entry. In Consideration of the acceptance of this entry, I (we) agree to be bound by the rules and regulations of the Canadian Kennel Club and any additional rules and regulations appearing in the premium list. Also, by signing this form I certify that I will not hold the Show giving Club, it's members, Directors, Employees, or Agents, liable in the event of any accident or misfortune however caused.				
Signature of Agent or Owner				Phone Number
a 15% + HST, charge applies on Credit Card Charges			Email address	
<input type="checkbox"/> VISA <input type="checkbox"/> MasterCard <input type="checkbox"/> AMEX		Expiry Date: Month > _____ Year > _____		
Card Number: _____ -- _____ -- _____ -- _____				
Name of Card Holder: _____				
Fax #		Mail To: COLMAR Show Service, In Canada: 340 Mercer St, Chatham, ON, Canada N7M 6E1		
519-351-3223		Web Site: www.colmars.com In USA: PO Box 142, Marine City, MI, USA 48039-0142		

All Fees are payable at time of entry. No entry will be processed or entered in this show without payment.
 Listing fees are applicable for all dogs entered in the shows that do not have an individual CKC Reg. Number or an ERN number.

Entry Information

*** All fees include HST ****

	Canadian Funds	US Funds
**Entry Fee, of each dog, per entry per show/day	\$ 29.00	\$ 29.00
Listing Fee – per dog, per show/day	\$ 9.55	\$ 9.55
All Non – Regular & Unofficial Classes & All Breed Brace.....	\$ 15.00	\$ 15.00
Exhibition Only.....	\$ 15.00	\$ 15.00
Specialty Brace.....	\$ 15.00	\$ 15.00
Specialty Parades (Must be in Exhibition or one Regular Classes).....	N/C	N/C
Sweepstakes	\$ 15.00	\$ 15.00
Pre-Ordered & Prepaid Catalogue	\$ 10.00	\$ 10.00

All Fees are payable at time of entry. No entry will be processed or entered in this show without payment.

Listing fees are applicable for all dogs entered in the shows that do not have an individual CKC Reg. Number or an ERN number.

Tendering of an NSF cheque in payment of entry fees shall be considered non-payment of fees (8.8.2).

****A service charge of \$35.00 CDN OR US FUNDS will be applied to all NSF cheques. ****

Make ALL cheques payable to: Stormont, Dundas, & Glengarry Dog Association

and MAIL TO: COLMAR Show Service, 340 Mercer St., Chatham, ON, Canada N7M 6E1

In USA: PO Box 142, Marine City, MI, USA 48039-0142

With the uncertainty and unreliability of the postal system and email, it is advisable to send your entry via priority post, registered mail, or Entryline. It is your responsibility to verify receipt of any electronic entries or email correspondence. We cannot be held responsible for mail lost in transit or misdirected electronically or physically.

Fax Entries - VISA - MasterCard & American Express - Entries

You may fax your entry directly to us at 519-351-3223. Also you may charge your entries to your Visa/MasterCard/AMEX. Include the card number, expiry date, and name on the card, on the entry form, or a separate piece of paper. A NON - REFUNDABLE administration fee of 15% plus HST will be charged.

All Credit Card Charges Will Be Made in Canadian Funds.

ANY REFUNDS WILL BE MADE IN CANADIAN FUNDS FROM THE SHOW GIVING CLUB.

**** US Postal Address ****

All entries must be received at the Marine City Post Office Box by 1:00 p.m. on the day of closing. Any entries received at the US Post Office Box after that time & date will be considered received after closing, and not eligible for entry into the show.

General Entry Information

- LIMITED NUMBER OF CATALOGUES WILL BE AVAILABLE AT THE SHOW FOR \$ 15.00 CDN/USD.
- To comply with instructions issued by the Canadian Kennel Club we will be unable to accept, cancel, or substitute an entry reaching our Show Secretary after the closing date, except for moving class dogs to Specials.
- All entry confirmations and Judging Schedules will be mailed as soon as possible after entries close.
- It is your responsibility to verify the receipt of any electronic entries prior to the advertised closing date. A valid means of payment must accompany all entries.
- In the event that the dog is absent, excused by a Veterinarian or Judge, disqualified, or barred from competition by action of the bench Committee, no entry fees will be refunded.
- There is no refund for duplicate entries. All efforts will be made to find all duplicate entries. However, if the entry has been processed and appears in the official catalogue, no refund will be made.
- The Stormont, Dundas, & Glengarry Dog Association & COLMAR Show Service will not be responsible for cash sent through the mail.
- Overpayments will be applied to the General Trophy fund. Therefore, please calculate fees carefully.
- No entry will be accepted unless accompanied by full entry fees. NO post-dated cheques.
- Incomplete entries will be returned. Handlers and agents please note the full address of all owners must be filled in. **Refunds will not be given for anyone double entering the same dog.**
- Exhibitors must abide by errors made in entering their dogs regardless of how or by whom the entries were made.
- Only dogs eligible for registration with CKC may enter this show and trial.
- **Bitches, when in season**, are not permitted to compete in the Trial, however, entry fees will be refunded, providing a veterinarian's certificate stating that the bitch was in season within the 10 day period preceding the trial, is submitted to the Trial Secretary, on or before the date of the trial.

The Stormont, Dundas, & Glengarry Dog Association reserves the right to refuse any entries, subject to CKC rules.

All Emails & Faxes

It will be the responsibility of the exhibitor to ensure that any electronic submission, either email or facsimile, or any document transmitted electronically reaches the proper authority or recipient within the times and limits as regulated for each document in the CKC Rules & Regulations.

Sent fax receipts and / or copies of sent emails will not be taken as evidence of receipt by the recipients.



ENTRYLINE - Dog Show Entry Service

PHONE: 1-800-293-2935 FAX: 1-519-754-0796 www.theentryline.com (a Secured Site)

" The Dog Show Entry Service that lets you focus on winning"

Entries taken until: 6:00 pm on day of closing This is a privately owned business and charges a fee for this service

BOOSTERS

Airedale Terrier Club of Canada

Saturday, Aug 25/12 – Judge: **Conny Gutierrez-Otero**

Through the generosity of friends and members The Airedale Terrier Club of Canada is pleased to offer the following prizes
BOB, BOS, BPIB, BOW, WB, & WD

Club Barbet Canada

Sunday, August 26, 2012

Judge: **Peggy Gutierrez-Otero**

Through the generosity of friends and the members of Club Barbet Canada the following prizes will be offered.
BOB, BOS, BPIB, BOW, WB & WD

Canadian Bloodhound Club

Sunday, August 26, 2012

Judge: **Conny Gutierrez-Otero**

Through the generosity of friends and members The Canadian Bloodhound Club is pleased to offer the following prizes
BOB, BOS, BPIB, BOW, WB, & WD.

Border Terrier Club of Ontario

Saturday, August 25, 2012

Judge: **Conny Gutierrez-Otero**

Through the generosity of friends and members The Border Terrier Club of Ontario is pleased to offer the following prizes
BOB, BOS, BPIB, BOW, WB, & WD.

Cairn Terrier Club of Canada – ON E Region

Saturday, August 25/12

Judge: **Conny Gutierrez-Otero**

Through the generosity of friends and members The Cairn Terrier Club of Canada- OER is pleased to offer the following prizes
BOB, BOS, BPIB, BOW, WB, & WD.

Dalmatian Club of Canada

Sunday Aug 26/12 Judge: **Rita Holloway**

Through the generosity of friends and members The Dalmatian Club of Canada is pleased to offer the following prizes
BOB, BOS, BPIB, BOW, WB, & WD
Prizes and/or Rosettes will be handed out for the highest scoring Dalmatian in the second Trials on Friday, August 24th, for Obedience, Rally, and Agility.

English Springer Spaniel Club of Canada

Sunday Aug 26/12 Judge: **Dr. Robert Smith**

Through the generosity of friends and members, the ESSCC will offer a ribbon or prize for BOB, BOS, WD, WB and BPIB.

ESSCC will offer a Rosette and /or prize for all qualifiers in the first trial on Sunday for Rally, Obedience and Agility. Scores from Obedience Trial number 5 will be considered for High In Trial which will receive a Rosette and appropriate prize

Norfolk Terrier Club of Ontario

Sunday, August 26, 2012 – Judge: **Dr. Robert Smith**

Through the generosity of friends and members The Norfolk Terrier Club of Ontario is pleased to offer the following prizes
BOB, BOS, BPIB, BOW, WB, & WD.

Ottawa Valley All Setter Association

Setters (Irish)

Sunday Aug 26/12 Judges: **Dr. Robert Smith**

Setters (English, Gordon, Irish Red & White)

Sunday Aug 26/12 Judge: **Peggy Gutierrez-Otero**

In lieu of prizes, the Ottawa Valley All Setter Association will be donating a portion of the rebate received to a charity of the club's choice..

Ottawa Valley Pointing Dog Club (All Pointing Breeds)

Saturday, August 25, 2012

Judges: **Dr. Robert Smith, Douglas Holloway**

Braque Français, Kleiner Munsterlander Vorstehhund, Wire-Haired Pointing Griffon, Pointer, Pointer (GLH, GSH, GWH), Pudelpointer, Setter (Irish, English, Gordon, Irish R & W), Spaniel (Blue Picardy, Brittany, French), Spinone Italiano, Vizsla (SM & WH), Weimaraner

In lieu of prizes, the Ottawa Valley Pointing Dog Club will be donating a portion of the rebate received to a charity of the club's choice

Rideau Terrier Club – All Terriers

Sunday, August 26, 2012 Judge: **Dr. Robert Smith**

Through the generosity of friends and members the Rideau Terrier Club is pleased to offer the following awards:
Group 1st, 2nd, 3rd, 4th & BPIG.

Standard Schnauzer Club of Canada

Sunday, August 26, 2012 Judge: **Rita Holloway**

Through the generosity of friends and members The SSCC is pleased to offer the following awards:
BB, BOS., BW, WD, WB., & BP
Highest scoring Std Schnauzer of the day in
Agility, Obedience & Rally Trials of SD&G

Legend of Abbreviations

BB = Best of Breed, **BOS** = Best Of Opposite Sex, **WD** = Winners Dog, **WB** = Winners Bitch, **BW** = Best of Winners,
BP = Best Puppy In Breed & **HQS** = Highest Qualifying Score, The Stormont, Dundas & Glengarry Dog Association is pleased to offer rosettes for Best Of Breed, Best Of Opposite Sex, Winners Dog, Winners Bitch, Best of Winners, Best Puppy In Breed The Clubs have offered to support the entry in their breed

Eukanuba

OFFICIAL CANADIAN KENNEL CLUB FORM			SD&G - CONFORMATION		Armband #
<input type="checkbox"/> Friday, August 24, 2012		<input type="checkbox"/> Sunday, August 26, 2012			
<input type="checkbox"/> Saturday, August 25, 2012		<input type="checkbox"/> Monday, August 27, 2012			
Obedience	<u>Dates</u>	Rally	Price List		
<input type="checkbox"/> Trial 1 <input type="checkbox"/> Trial 2	Friday August 24, 2012	<input type="checkbox"/> Trial 1 <input type="checkbox"/> Trial 2	Entry Fee: \$ 29.00 CDN/USD Listing Fee: \$ 9.55 CDN or USD Other Fees: Sweepstakes, Exhibition, & Non - Regular - \$ 15.00 CDN or USD		
<input type="checkbox"/> Trial 3 <input type="checkbox"/> Trial 4	Saturday, August 25, 2012	<input type="checkbox"/> Trial 3 <input type="checkbox"/> Trial 4			
<input type="checkbox"/> Trial 5 <input type="checkbox"/> Trial 6	Sunday, August 26, 2012	<input type="checkbox"/> Trial 5 <input type="checkbox"/> Trial 6			
<input type="checkbox"/> Pre Paid and Pre Ordered Catalogue \$ 10.00 CDN/USD			Entries Close: Tuesday JULY 31, 2012 at 8 pm		
Please Make ALL Cheques For Payable to SD & G Dog Association			TOTAL FEES FOR THIS ENTRY: \$		
Conformation	Rally (Limited Entry)		Obedience (Limited Entry)		
<input type="checkbox"/> Jr. Puppy (6 - 9 mth) <input type="checkbox"/> Open	Jump Heights		<input type="checkbox"/> Pre - Novice <input type="checkbox"/> Open A <input type="checkbox"/> Utility A		
<input type="checkbox"/> Sr. Puppy (9 - 12 mth) <input type="checkbox"/> Specials Only	<input type="checkbox"/> 6" <input type="checkbox"/> 8" <input type="checkbox"/> 12" <input type="checkbox"/> 16"		<input type="checkbox"/> Novice A <input type="checkbox"/> Open B <input type="checkbox"/> Utility B		
<input type="checkbox"/> 12 - 18 month	<input type="checkbox"/> Novice A <input type="checkbox"/> Novice B		<input type="checkbox"/> Novice B <input type="checkbox"/> Exhibition		
<input type="checkbox"/> Canadian Bred <input type="checkbox"/> Brace (Sun Only)	<input type="checkbox"/> Advanced A <input type="checkbox"/> Advanced B		<input type="checkbox"/> Novice C		
<input type="checkbox"/> Bred By Exhibitor <input type="checkbox"/> Exhibition	<input type="checkbox"/> Excellent A <input type="checkbox"/> Excellent B		<input type="checkbox"/> Intermediate Novice		
BREED			SEX: <input type="checkbox"/> MALE OR <input type="checkbox"/> FEMALE		
REGISTERED NAME OF DOG					
Check One & Enter Number Here			Date Of Birth: Please Circle Month		IS THIS A PUPPY?
<input type="checkbox"/> CKC Reg #			Jan Feb Mar Apr May June		<input type="checkbox"/> Yes or <input type="checkbox"/> No
<input type="checkbox"/> CKC PEN #			July Aug Sept Oct Nov Dec		PLACE OF BIRTH?
<input type="checkbox"/> CKC ERN #			Day _____ Year _____		<input type="checkbox"/> Canada
<input type="checkbox"/> CKC Misc Cert.#					<input type="checkbox"/> Elsewhere
<input type="checkbox"/> LISTED					
BREEDER(S)					
SIRE					
DAM					
REGISTERED OWNER(S)					
OWNER'S ADDRESS					
CITY		PROV/STATE		POSTAL CODE/ZIP	
NAME OF OWNERS AGENT (IF ANY) AT THE SHOW					
AGENT'S ADDRESS					
CITY		PROV/STATE		POSTAL CODE/ZIP	
Mail ID to: <input type="checkbox"/> OWNER Or <input type="checkbox"/> AGENT					
I certify that I am the registered Owner(s) of the dog or that I am the authorized agent of the Owner(s) whose name(s) I have entered above and accept full responsibility for all statements made in this entry. In Consideration of the acceptance of this entry, I (we) agree to be bound by the rules and regulations of the Canadian Kennel Club and any additional rules and regulations appearing in the premium list. Also, by signing this form I certify that I will not hold the Show giving Club, it's members, Directors, Employees, or Agents, liable in the event of any accident or misfortune however caused.					
Signature of Agent or Owner				Phone Number	
a 15% + HST, charge applies on Credit Card Charges			Email address		
<input type="checkbox"/> VISA <input type="checkbox"/> MasterCard <input type="checkbox"/> AMEX		Expiry Date: Month > _____ Year > _____			
Card Number: _____ -- _____ -- _____ -- _____					
Name of Card Holder: _____					
Fax #		Mail To: COLMAR Show Service, In Canada: 340 Mercer St, Chatham, ON, Canada N7M 6E1			
519-351-3223		Web Site: www.colmars.com In USA: PO Box 142, Marine City, MI, USA 48039-0142			

All Fees are payable at time of entry. No entry will be processed or entered in this show without payment.

EVENT REGISTRATION NUMBER (ERN)

Effective Jan 1/92, all dogs that are foreign born and foreign owned and enter Canada for the sole purpose of entering CKC events will no longer require a CKC registration number, but will require an Event Registration Number (ERN). The ERN number MUST be applied for within 30 days of the first day of entering a CKC event. For further information, contact: **The Canadian Kennel Club**

Phone (416) 675-5511 FAX (416) 675-6506 HOURS: 9:00 a.m. – 5:00 p.m.

GENERAL INFORMATION

CKC Conformation Rules & Regulations 12.2.2 - PUPPIES 3-6 Months (January 1, 2007)

- a) Dogs 3 months of age and under 6 months of age on the day of the show may be entered in Exhibition Only, providing that the owner of the puppies has also entered a dog in one of the regular official classes.
b) Puppies in this category may not compete in any official, unofficial or non-regular classes including parades.

COLMAR Note: Listing Fees do not apply & need not be paid for "Exhibition Only" entries.

- ◆ Limited number of catalogues will be available at the show. (Pre-ordering is highly recommended.)
- ◆ The show precincts **30 feet from any ring or building housing show executives.**
- ◆ **"No Show - All Breed or Specialty, Event, Performance Event, or Best in Show Judging, shall be delayed for any Exhibitor who has a conflict in another ring or event. All exhibitors are expected to have alternative arrangements made for any possible conflict."**
- ◆ The Show Superintendent has the authority to ask exhibitors to move or take down any crates and private exercise pens, etc. Failure to do so when requested could result in disciplinary action.
- ◆ Exhibitors are requested to keep their grooming and crating areas clean and tidy. If space is at a premium, exhibitors must remove exercise pens if requested by the Show Superintendent or designate.
- ◆ Dogs not entered in these shows will NOT be allowed within the precincts of the show & trial.
- ◆ The Show Superintendent will be in full charge of the show, governed by CKC rules.
- ◆ If, because of riot, civil disturbance, or other acts beyond the controls of the management, it is impossible to open or complete the show or trial, no refund of Entry Fees will be made.
- ◆ It shall be the duty and obligation of the show-giving club to ensure that a judge or any show committee members are not subjected to any indignities. The Conformation Show Committee shall promptly report to the CKC any infringement of this regulation, and the Discipline Committee will have the authority to take such action as it deems fit on receipt of a report indicating that this has occurred.
- ◆ The COLMAR Show Service & the Stormont, Dundas, & Glengarry Dog Association will use care and diligence for the welfare of all dogs, exhibitors and spectators, but will not be responsible for, nor assume any liability in the event of accident or misfortunes, however caused.
- ◆ Dogs need only to arrive 15 minutes before scheduled judging time and will be excused from each show when not required for further judging. Waiting for dogs will not be possible and handlers with several breeds must arrange for alternate handlers if judging times for their breeds conflict.
- ◆ COLMAR Show Service will only collect and utilize data and information that you provide us, and only for the purposes of the service we provide exhibitors entering a CKC (Canadian Kennel Club) event, and the subsequent documents generated for this event, and required by the CKC. The type and accuracy of the information is solely contingent upon what you voluntarily provide to us. We will not use or disclose personal information for the purposes other than those for which it was collected, except with consent or as required by law. Personal information will not be retained longer than needed for the specified purposes.

SD & G Junior Handling Conformation

All Junior Handling Classes offered - **Sunday, August 26, 2012 Judge: TBA**

All Juniors should register with the Show Secretary one hour before competition. Stormont, Dundas & Glengarry Dog Association is pleased to offer Flats for 1st to 4th in each class, and a Rosette for Best Junior Handler overall.

Prizes For Junior Handling Sponsored By Best in Show - Show Supplies



Eukanuba®

Champions and Championship Points

Chapter 15.1 A dog awarded WINNERS at a championship show shall be credited with a number of championship points (ranging from 0 to 5) and the number of championship points credited to a dog awarded WINNERS shall be as provided hereunder.

15.1.2 The schedule to be employed in the determination of the number of points to be allocated a dog awarded Winners shall be:

Dogs Competing*	1	2	3 to 5	6 to 9	10 to 12	13 or more
Points Allocated *includes the dog awarded WINNERS	0	1	2	3	4	5

In counting the number of eligible dogs in competition, a dog that is disqualified, dismissed, excused or ordered from the ring by the judge shall **NOT** be included in the calculation for championship points.

Note: To determine the number of championship points earned by a dog awarded WINNERS, total all the dogs in competition which the dog defeated, directly or indirectly, for the highest of the following official breed awards, Winners, Best of Winners, Best of Breed, or Best of Opposite Sex, then consult the schedule set forth above.

Section 15.1.8, ... a dog awarded WINNERS which also places in the regular group competition shall be credited with the following additional points, provided that a dog was defeated at the Group level.

Number of breeds competing at Group level	Dog placed First	Dog Placed Second	Dog Placed Third	Dog Placed Fourth
13 or more	5	4	3	2
10 to 12	4	3	2	1
6 to 9	3	2	1	1
5	2	1	1	1
4	2	1	1	0
3	2	1	0	0
2	1	0	0	0
1	0	0	0	0

Section 15.1.9, A dog may not be credited with more than five (5) championship points in a single show.

Section 15.1.11, A dog awarded WINNERS which also places Best in Show at an all-breed Championship Show shall be credited with five (5) championship points inclusive of any points earned at breed or group level.

Section 15.1.12 (c), In order for a dog to be recognized as a Champion and its owner provided with a Championship certificate, the dog must...have earned at least one 2 point win either at the breed or group level.

Moving a Class Dog to Specials

Chapter 8, Section 8.9.1, A dog which is individually registered in the records of the Canadian Kennel Club, and has completed the requirements for a championship in accordance with these rules but at the time of the closing of entries for a show has not received confirmation of the title, may be transferred from one of the regular classes to "Specials Only", providing the transfer is submitted to the Show Secretary in WRITING by the owner or handler at least one (1) hour prior to the opening of the show.

Section 8.9.3, When one or more all-breed and/or specialty shows are held on the same day, in the same venue, the request for moving of class dogs to specials must be made prior to the scheduled opening of the first show.

Every day of a 2 or more day show is a separate show. Please note that this rule is effective up to one (1) hour prior to the opening of the show, NOT one hour prior to the judging of the breed.

CKC Rules & Regulations 4.1.3 - A judge officiating at a show held under these rules shall not be subjected to indignities of any kind during the progress of the show. It shall be the duty and obligation of the club holding the show to see that this rule is effectively carried out.

Trophy List

Though the generosity of members and friends, the Stormont, Dundas, & Glengarry Dog Association, is pleased to offer prizes and Rosettes for the following each day:

- Best in Show, Best Puppy in Show, High In Trial, High in Obedience & Rally Class,
- First in Each Group, Best Puppy in Each Group. Rosettes for Best Brace in Group & Show
- Performance Event New Title Rosettes will be offered to any Exhibitor that receives their Title in Obedience, Rally, or Agility, at these Trials.

It is the exhibitors' responsibility to pick up their rosette, all rosettes must be picked up at the show.

No rosettes will be mailed.

Best In Show Dog show supplies will be offering gift certificates for Best Brace in Group and Best Brace Overall.

NON CKC MEMBER PARTICIPATION FEE - CANADIAN RESIDENTS ONLY Effective April, 2011.

The CKC will be instituting a Non-Member Participation fee for all Canadian residents who participate in a CKC event but are not CKC members. The non member participation fee is paid in any year a title is earned and covers all titles and dogs owned by that individual. In order to protect the awards/titles earned, the non-member will have a choice either to become a CKC member or to pay the non-member participation fee. Failure to comply within 30 days of notification will cause all awards and titles to be cancelled This applies to dogs wholly owned by non members resident in Canada, and does not apply to U.S. exhibitors nor to CKC members or dogs co-owned with a CKC member

OFFICIAL CANADIAN KENNEL CLUB FORM			Armband #	
SD&G - CONFORMATION				
<input type="checkbox"/> Friday, August 24, 2012		<input type="checkbox"/> Sunday, August 26, 2012		
<input type="checkbox"/> Saturday, August 25, 2012		<input type="checkbox"/> Monday, August 27, 2012		
Obedience		Dates		Rally
<input type="checkbox"/> Trial 1 <input type="checkbox"/> Trial 2		Friday August 24, 2012		<input type="checkbox"/> Trial 1 <input type="checkbox"/> Trial 2
<input type="checkbox"/> Trial 3 <input type="checkbox"/> Trial 4		Saturday, August 25, 2012		<input type="checkbox"/> Trial 3 <input type="checkbox"/> Trial 4
<input type="checkbox"/> Trial 5 <input type="checkbox"/> Trial 6		Sunday, August 26, 2012		<input type="checkbox"/> Trial 5 <input type="checkbox"/> Trial 6
Price List				
Entry Fee: \$ 29.00 CDN/USD				
Listing Fee: \$ 9.55 CDN or USD				
Other Fees: Sweepstakes, Exhibition, & Non - Regular - \$ 15.00 CDN or USD				
<input type="checkbox"/> Pre Paid and Pre Ordered Catalogue \$ 10.00 CDN/USD Entries Close: Tuesday JULY 31, 2012 at 8 pm				
Please Make ALL Cheques For Payable to SD & G Dog Association TOTAL FEES FOR THIS ENTRY: \$				
Conformation		Rally (Limited Entry)		Obedience (Limited Entry)
<input type="checkbox"/> Jr. Puppy (6 - 9 mth) <input type="checkbox"/> Open		Jump Heights		<input type="checkbox"/> Pre - Novice <input type="checkbox"/> Open A <input type="checkbox"/> Utility A
<input type="checkbox"/> Sr. Puppy (9 - 12 mth) <input type="checkbox"/> Specials Only		<input type="checkbox"/> 6" <input type="checkbox"/> 8" <input type="checkbox"/> 12" <input type="checkbox"/> 16"		<input type="checkbox"/> Novice A <input type="checkbox"/> Open B <input type="checkbox"/> Utility B
<input type="checkbox"/> 12 - 18 month		<input type="checkbox"/> Novice A <input type="checkbox"/> Novice B		<input type="checkbox"/> Novice B <input type="checkbox"/> Exhibition
<input type="checkbox"/> Canadian Bred <input type="checkbox"/> Brace (Sun Only)		<input type="checkbox"/> Advanced A <input type="checkbox"/> Advanced B		<input type="checkbox"/> Novice C
<input type="checkbox"/> Bred By Exhibitor <input type="checkbox"/> Exhibition		<input type="checkbox"/> Excellent A <input type="checkbox"/> Excellent B		<input type="checkbox"/> Intermediate Novice
BREED				SEX: <input type="checkbox"/> MALE OR <input type="checkbox"/> FEMALE
REGISTERED NAME OF DOG				
Check One & Enter Number Here			IS THIS A PUPPY?	
<input type="checkbox"/> CKC Reg #			<input type="checkbox"/> Yes or <input type="checkbox"/> No	
<input type="checkbox"/> CKC PEN #			PLACE OF BIRTH?	
<input type="checkbox"/> CKC ERN #			<input type="checkbox"/> Canada	
<input type="checkbox"/> CKC Misc Cert.#			<input type="checkbox"/> Elsewhere	
<input type="checkbox"/> LISTED				
BREEDER(S)				
SIRE				
DAM				
REGISTERED OWNER(S)				
OWNER'S ADDRESS				
CITY		PROV/STATE		POSTAL CODE/ZIP
NAME OF OWNERS AGENT (IF ANY) AT THE SHOW				
AGENT'S ADDRESS				
CITY		PROV/STATE		POSTAL CODE/ZIP
Mail ID to: <input type="checkbox"/> OWNER Or <input type="checkbox"/> AGENT				
I certify that I am the registered Owner(s) of the dog or that I am the authorized agent of the Owner(s) whose name(s) I have entered above and accept full responsibility for all statements made in this entry. In Consideration of the acceptance of this entry, I (we) agree to be bound by the rules and regulations of the Canadian Kennel Club and any additional rules and regulations appearing in the premium list. Also, by signing this form I certify that I will not hold the Show giving Club, it's members, Directors, Employees, or Agents, liable in the event of any accident or misfortune however caused.				
Signature of Agent or Owner				Phone Number
a 15% + HST, charge applies on Credit Card Charges				Email address
<input type="checkbox"/> VISA <input type="checkbox"/> MasterCard <input type="checkbox"/> AMEX		Expiry Date: Month > _____ Year > _____		
Card Number: _____ -- _____ -- _____ -- _____				
Name of Card Holder: _____				
Fax #		Mail To: COLMAR Show Service, In Canada: 340 Mercer St, Chatham, ON, Canada N7M 6E1		
519-351-3223		Web Site: www.colmars.com In USA: PO Box 142, Marine City, MI, USA 48039-0142		

All Fees are payable at time of entry. No entry will be processed or entered in this show without payment.

SPECIALTY SHOW - Saturday August 25, 2012
Club Barbet Canada

CONFORMATION - Regular & Non-Regular Classes

Dr. Francisco Chapa, MEXICO 64550

SWEEPSTAKES – All Sweepstakes Classes

Jim Bricknell, 690 Pinegrove Rd., RR1, Roblin, ON, K0K 2W0



OFFICERS

President	Louise Nadeau	Vice-President	Janet Black Evans
Treasurer.....	Isabelle Ringuet	Secretary	Isabelle Ringuet
Show Superintendent	Jodie O'Meara	Show Secretary.....	COLMAR Show Service

**Directors - Prairies Region - Heath Kenyon, Ontario - Florence E. Erwin, & Stephanie Dixon,
Quebec - Michel Raymond Atlantic - Jean Baker,**

CLASSES - Divided by Sex

Regular Classes: Junior (6-9), Senior (9-12), (12-18), Canadian Bred, Bred By Exhibitor, Open, Veteran, Specials Only, Sexually Altered, and Exhibition only.

Non Regular Classes: Gun Dog, Stud Dog, Brood Bitch, Brace, Parade of Titleholders.

TROPHIES AND ROSETTES

Through the generosity of Sponsors, Friends and Members of Club Barbet Canada, a suitable Trophy or Prize &/or Rosette or Ribbon will be offered for Best of Breed, Best of Opposite, Best Puppy in Breed, Winners (Male & Female), Best of Winners, Reserve Winners (Male & Female), Canadian Bred (Male & Female), Best Canadian Bred, Bred by Exhibitor (Male & Female), Best Bred By Exhibitor, Veterans (Male & Female), Best Veteran, Altered (Male & Female), Best Altered in Breed, Best Brace, Best Stud Dog, Best Brood Bitch, Gun Dog (Male & Female), Best Gun Dog, Rosettes are offered by the Friends and Members of Club Barbet Canada for the Parade of Titleholders (one per participant). **Award Of Merit:** One rosette and/or Trophy/Prize will be offered for every ten dogs competing at Best of Breed level, awards of merit will be presented at the discretion of the judge. *(All Dogs Entering the ring to Compete for Best Of Breed will be counted).*

Obedience, Rally & Agility

Obedience, Rally & Agility Trophies and/or Rosettes will be handed out for the Highest Qualifying Score by a Barbet in the first SD & G Obedience Trial, Rally Trial & Agility Trial of the day on Friday August 24th.

Field Event: Barbet are eligible to participate in the CKC WC, WCI, and WCX trials held on Sunday August 26, 2012 at Ambertrail Kennels in Maxville, ON. Contact Stephanie Dixon at northrock1@sympatico.ca or 416-773-0843 for details

Hat Trick- A prize will be awarded (one per dog) to each Barbet that receives a placement and/or a qualifying score in three different events comprising of Conformation, Obedience, Rally-O, Agility & Field over the course of the weekend. A participation prize (one per dog) will be awarded to each Barbet entered in one or more of the performance events over the course of the weekend (obedience, rally-o, agility, field).

SWEEPSTAKES

Please Note: All Dogs entered in Sweepstakes must also be entered in one of the official classes at the specialty **This specialty will include as follows:** All classes are to be divided by sex, 6 - 9 Mths, 9 -12 Mths, 12 -18 Mths.

Prizes: Prize money will be divided as follows in each class:

25% First place in each class, 20% Second place in each class

15% Third place in each class, 10% Fourth place in each class

5% to be divided equally between Best in Sweepstakes and Best of Opposite Sex in Sweepstakes

Balance of 25% will be retained for Administration.

Through the generosity of Friends and Members of Club Barbet Canada a Trophy and/or Rosette will be awarded to Best in Sweeps and Best of Opposite Sex in Sweepstakes.

Host Hotel Information

Best Western Plus Parkway Inn & Conference Centre – 613-932-0451

1515 Vincent Massey Drive, Cornwall, On. K6H 5R6 A block of rooms have been set aside for the club

Our Banquet Hall has been reserved for the night of the Specialty – August 25, 2012.

To Order tickets contact Janet Black Evans at janetblackevans@rogers.com

Meet & Greet – After Best In Show Fri Aug 24th - Club Barbet Canada Tent next to the grooming tent

DNA Clinic – AKC DNA Profile Clinic - \$30 per dog, pre-registration and payment required. Deadline August 12, 2011. Date and time to be announced when we get the show schedule. Contact Stephanie Dixon at northrock1@sympatico.ca or 416-773-0843 for details.

Breed Seminar – Date and time to be announced when we get the show schedule.

Grooming Seminar – Date and time to be announced when we get the show schedule.

For more information about the Club Barbet Canada National Specialty, visit the website at www.barbet.comuf.com or contact Florence Erwin at eflorence@bell.net or 905-821-9028

SPECIALTY SHOW
CANADIAN BLOODHOUND CLUB
Saturday August 25, 2012

CONFORMATION - Regular & Non-Regular Classes

Pamela E Bruce, 314 The Kingsway, Suite 6, Etobicoke, ON M9A 3V2

SWEEPSTAKES – All Sweepstakes Classes

PROUDLY SPONSORED BY

Joe Panaro, 1491 Scottanne St., Greely, ON K4P 1G8



OFFICERS

President	Veronica Mercer	Vice-President	Tammy Arseneau
Treasurer	Maggie O'Brien	Secretary	Patrina McBride
Show Chair	Jodie O'Meara		
Show Superintendent	Jodie O'Meara	Show Secretary	COLMAR Show Service

CLASSES - Divided by Sex

Regular Classes: Jr (6-9), Sr (9-12), (12-18), Cdn Bred, Bred By Ex, Open, Veteran, Specials Only
& Altered (spayed/neutred dogs allowed in Veterans class)

Non – Regular: Exhibition Only, Stud Dog, Brood Bitch, Brace.

TROPHIES AND ROSETTES

Through the generosity of Friends and Members of the Canadian Bloodhound Club a suitable Trophy &/or Rosettes will be offered Best of Breed, Best of Opposite, Best Puppy in Breed, Winners (Male & Female), Best of Winners, Reserve Winners (Male & Female), Best Veteran Male & Female, First in each Regular Class, Best Altered in breed, Best Opposite Altered, Best Stud Dog, Best Brood Bitch, Best Brace.

A suitable Trophy &/or Rosette will be offered to Highest Qualifying Score by an Bloodhound in the SD & G Obedience Trial(s) & Rally Trials, on the day of the specialty.

A Perpetual trophy will be awarded for the Best of Breed and will be retained by the Canadian Bloodhound Club.

Award Of Merit: One rosette will be offered for every ten dogs competing at Best of Breed level. Awards of merit will be presented at the discretion of the judge. (All Dogs Entering the ring to Compete for Best Of Breed will be counted).

SWEEPSTAKES (All ages as of the day of the specialty)

Please Note: All Dogs entered in Sweepstakes must also be entered in one of the official classes at the specialty.

This specialty will include SWEEPSTAKES, VETERAN SWEEPSTAKES as follows:

All Regular Sweepstakes classes divided by sex – (Divided by Sex), 6 - 9 mos, 9 -12 mos, 12 -18 mos, 18 – 24 mos.

All Veteran Sweepstakes classes are to be divided by sex – 7 - 9 Years, 9 -11 Years, 11 years +,.

PRIZES (Regular & Veteran) Prize money will be divided as follows:

Best in SweepstakesTrophy, Rosette & 50% of entry fees.

Best of Opposite in SweepstakesTrophy, Rosette & 25% of entry fees.

25% will be retained by club for administration.

Rosettes and prizes will be awarded for Best in Sweepstakes and Best of Opposite in Sweepstakes.

JUNIOR HANDLING will be offered at this show – Judge & Time TBA

Social - Gathering Scheduled for Saturday evening,
Dinner, Auction, HOF Awards, Watch the club website for details.

Trailing Event

Details and forms will be available on the club website as it becomes available.

For More information regarding this specialty
visit www.canadianbloodhoundclub.com

SPECIALTY SHOW
Dalmatian Club of Canada
Saturday, August 25, 2012

CONFORMATION - Regular & Non-Regular Classes

Robert Rivard, 83 Central Pike, Foster, RI USA 02825

SWEEPSTAKES – All Sweepstakes Classes

Judie Rivard, 83 Central Pike, Foster, RI USA 02825

OFFICERS

PresidentCarola Adams Vice-PresidentJohn Bolen
TreasurerHelen Lipinski SecretaryAlta Walker
Directors: **BC** - Betty Pirs, **Prairies**- Patti Pella **Alberta**- Bonnie Heatherington,
Maritime - Jennifer Stockman, **Ontario** - Richard Millaire

Show ChairRichard Millaire
Show SuperintendentJodie O'Meara Show Secretary COLMAR Show Service

Regular Classes - (divided by sex) - Jr Puppy 6- 9 mos, Sr Puppy 9- 12 mos, 12 - 18 Month,
Canadian Bred, Bred by Exhibitor, Open (divided By Colour – Black,Lliver), Specials Only,
Veterans (7 to 10yrs, & 10 yrs +), & Sexually Altered Class

Non-Regular Classes - Exhibition Only, Brace Class, Stud Dog, Brood Bitch

TROPHIES AND ROSETTES

Rosettes &/or Trophies will be given for all Regular Class awards and placements, including Best Puppy,
Non-Regular Class awards and placements, Unofficial Class awards. Rosettes & Rosettes &/or Trophies
will also be given for the Altered Class as follows:

Best Altered in Breed, Best Altered Male and Female.

Trophies &/or Rosettes will be given for the Highest Qualifying Score for a Dalmatian in the SD& G all
breed trials in Obedience, Rally and Agility when entered in the second trials on Friday August 24th..
Award Of Merit: One rosette will be offered for every ten dogs competing at Best of Breed level. Awards of merit will be
presented at the discretion of the judge.

Sweepstakes

Please Note: All Dogs entered in Sweepstakes must also be entered in one of the regular classes at the specialty.
This specialty will include Regular and Veteran Sweepstakes as follows:
Sweepstakes classes (divided by sex) - 6 - 9 Mos, 9 -12 Mos, & 12 -18 Mos, as of the day of the specialty.
Veteran Sweepstakes (divided by sex) – 7 - 9 years and 10 years & over, as of the day of the specialty.

Prizes: SWEEPSTAKES & VETERAN SWEEPSTAKES

Best in Sweepstakes 40% of entry money

Best of Opposite in Sweepstakes..... 40% of entry money

20% will be retained by SD & G DA for administration.

Rosettes and prizes will be awarded for

Best in Sweepstakes and Best of Opposite in Sweepstakes

JUNIOR HANDLING (All Conformation Classes Offered)

Junior Handling Judge – TBA

Rosettes offered for Best Junior Handler, Reserve Junior Handler and Pee Wee.

For More information regarding this specialty
Carola Adams, dutchkennels@rogers.com

**National Specialty Show
Norfolk Terrier Club of Canada
Saturday August, 25, 2012**

Judges

CONFORMATION Regular and Non Regular classes

Dr. Francisco Chapa, 4a Vidriera 1505 Ote ,Col Cantu,Monterrey, N.L., MEXICO 64550

Sweepstakes

Jennifer Prawel-Tirone

Officers

President..... Linda Dowdle Vice-President Lee Goodfellow
Secretary Sarah Paquette Treasurer Susan Chronowic

SHOW COMMITTEE

Chairperson Judy White
Show Superintendent Jodie O'Meara
Show Secretary COLMAR Show Service

CLASSES - Divided by Sex

Regular Classes: Junior (6-9), Senior (9-12), (12-18), Canadian Bred, Bred By Exhibitor, Open, Veteran, Specials Only, Sexually Altered, and Exhibition only.

Non-Regular Classes: Stud Dog, Brood Bitch

Note: Dogs entered for the non-regular classes must also be entered in one of the official classes or Exhibition Only. If entered in non-regular classes, spayed/neutered dogs must be entered in exhibition only.

PRIZES

Through the generosity of members and friends, the Norfolk Terrier Club of Canada will offer a suitable trophy and rosette for the following: Best of Breed, Best of Opposite, Best of Winners, Best Puppy in Breed, Best Canadian Bred, Winners Male & Female, Reserve Winners Male & Female, Veteran Male & Female, Best Stud Dog, Best Brood Bitch, and Best Canadian Dog in Specialty.

AWARD OF MERIT: One Rosette will be offered for for every ten dogs entering the Best of Breed ring. Award of Merit will be presented at the discretion of the Judge.

SWEEPSTAKES All ages are as of the day of the specialty.

Please Note: All Dogs entered in Sweepstakes must also be entered in one of the official classes at the specialty

Sweepstakes classes: (Divided by Sex), 6 - 9 Months, 9 -12 Months, 12 - 18 Months.

Veteran Sweepstakes classes: (Divided by Sex), 7-10 years, 10 years +.

Prizes: Prize money will be awarded as follows:

after administration fees (no more than 25% of entry fees)

Best In Sweepstakes - Rosette and 60% of entry fees after expenses,

Best of Opposite Sex - Rosette and 40% of entry fees after expenses,

Ribbons will be awarded first through fourth in each class

JUNIOR HANDLING

The Norfolk Terrier Club of Canada will endeavor to ensure each Junior entered is provided with a Norfolk Terrier for this competition.

For more information about the specialty

Contact

Judy White - jaketkennels@rogers.com

NOVA SCOTIA DUCK TOLLING RETRIEVER CLUB OF CANADA
EASTERN ONTARIO TOLLER REGIONAL SPECIALTY
Saturday August, 25, 2012

CONFORMATION - Regular & Non-Regular Classes

Stephen J. Dainard, 8109 Beaver Glen Dr., Niagara Falls, ON L2H 3K5

SWEEPSTAKES – All Sweepstakes Classes

Leslie Grant, 7630 Harnett Rd., RR #2, North Gower, ON K0A 2T0

OFFICERS

President.....	Krista Wendland	Vice-President.....	Alison Strang
Secretary.....	Shelly Campbell	Treasurer	Stephanie Halse
Show Chair.....	Jodie O'Meara		
Show Superintendent	Jodie O'Meara	Show Secretary	COLMAR Show Service

CLASSES - Divided by Sex

Regular Classes: Jr (6-9), Sr (9-12), (12-18), Canadian Bred, Bred By Exhibitor, Open, Veteran, Specials Only, & Sexually Altered. **Non – Regular Classes:** Exhibition Only, Stud Dog, Brood Bitch, Brace, Gun Dog

TROPHIES AND ROSETTES

Rosettes and/or Trophies are offered by sponsors, friends, & members of the NSDTRCC for

Conformation: Best of Breed, Best of Opposite, Best of Winners, Best Puppy, Best Veteran, Best Sire and Get, Best Dam and Progeny, Best Gun Dog, Best Gun Dog Opposite, Best Brace, Junior Puppy Male & Female, Senior Puppy Male & Female, 12-18 Month Male & Female, Canadian Bred Male & Female, Bred by Exhibitor Male & Female, Open Male & Female, Reserve Winners Male & Female, Winners Male & Female, Veterans Male & Female,.

Conformation Altered: Best Altered in Breed, Best of Opposite Altered,

Award Of Merit: One rosette will be offered for every ten dogs competing at Best of Breed level. Awards of merit will be presented at the discretion of the judge.

Obedience: Highest Qualifying Toller In the Second SD & G trial of the day on Friday August 24, 2012

Agility: Highest Qualifying Toller In the Second SD & G trial of the day on Friday August 24, 2012

Rally: Highest Qualifying Toller In the Second SD & G trial of the day on Friday August 24, 2012

SWEEPSTAKES

Please Note: All Dogs entered in Sweepstakes must also be entered in one of the regular classes at the specialty. This specialty will include Sweepstakes, & Veteran Sweepstakes as follows:

All Regular Sweepstakes classes divided by sex; 6-9 Mos, 9 -12 Mos, & 12 -18 Mos, as of the day of the specialty.

All Veteran Sweepstakes classes are to be divided by sex; 7-9 yrs, 10 years and over, as of the day of the specialty.

PRIZES: Prize money will be divided as follows:

Best in Sweepstakes - 25 % of total entries	Best of Opposite Sex to Best in Sweepstakes - 20% of total entries
First Prize..... 15% of entries for that class	Third Prize 5% of entries for that class
Second Prize..... 7.5% of entries for that class	Fourth Prize 2.5% of entries for that class
25% will be retained by the club for administration.	

Rosettes and/or prizes will be awarded for Best in Sweepstakes and Best of Opposite in Sweepstakes.

Junior Handling

Trophy & Rosette will be awarded for Best Overall Junior Handler. Rosettes will be awarded for 1st in each class.

2012 SPECIALTY - HOST HOTEL

Comfort Inn - 1625 Vincent Massey Drive , Cornwall, ON, K6H 5R6

Reservations: direct: (613) 937-0111 or 1-800-424-6423 Rate is \$ 105.00 CDN plus taxes per night

No Fee for dogs

Please phone the hotel directly to make reservations. Tell them you are booking a room under the group "Ontario Toller Specialty".

BBQ: On Site - To reserve your ticket contact Annette McAleer at - acmcaleer@mac.com

SPECIAL EVENT: The club is also holding WC, WCI, and WCX trials on Sunday

August 26, 2012 at Ambertrail Kennels. Please check out the website at

<http://www.eastontollerspecialty.netau.net/> for further information"

For more information about the Nova Scotia Duck Tolling Retriever Club of Canada Regional Specialty

<http://www.eastontollerspecialty.netau.net/>

Annette McAleer – acmcaleer@mac.com

SPECIALTY SHOW for ALL Setters (English, Gordon, Irish and Irish Red & White)

OTTAWA VALLEY ALL SETTER ASSOCIATION

PROUDLY SPONSORED BY

Thirty-Seventh Annual Specialty Show



Saturday, August 25, 2012



CONFORMATION - Regular & Non-Regular Classes

Mrs. Thora Brown, 5498 Appleton Rd. RR 4, Almonte, ON KOA 1A0

SWEEPSTAKES All Classes -

Mrs. Kim Aston, Fox Hill Farm, 2320 Upper Dwyer Hill Rd., Carp ON KOA 1L0

OFFICERS

President – Joan Colbourn Vice-President – Noreena Seery Treasurer- Deborah Cook
Secretary – Tina Cockram Membership – Debbie Cook Rescue - Patrick & Vicky Hunt
Directors – Beverley Kelsey, Laura Logan, Wendy Watson
Show Secretary - COLMAR Show Service

CLASSES - Divided by Sex Regular Classes: Jr (6-9), Sr (9-12), (12-18), CDN Bred, Bred By Ex, Open, Veteran, Specials Only. (Please Note Spayed/Neutered dogs may participate in the Veteran class)

Non – Regular Classes: Exhibition Only, Stud Dog, Brood Bitch & Brace, All Setter breeds combined. Field Dog, must have one leg towards Field Title & all Setter Breeds & sexes combined Entries in these classes may be spayed or neutered & must be entered in any OVASA Specialty class or Exhibition Only. Judging of these Non-Regular Classes will be held immediately after Best of Breed of the Last Setter Breed

Unofficial Classes: Best Setter in Multiple Breed Specialty (Best Setter in each breed to compete), Best Setter Puppy in Multiple Breed Specialty (Best Setter Puppy in each breed to compete), Best Setter Veteran in Multiple Breed Specialty (1st place Veteran Dog and 1st place Veteran Bitch in each breed to complete. There will be no Best Veteran Award at Breed Level).

Parade of Rescue Dogs: For Setter Dogs or Bitches that have been placed in a new home by the Rescue System
No fee and no registration number required. May be spayed or neutered. Non-competitive.

TROPHIES AND ROSETTES

Through the kindness and generosity of its members and friends, OVASA is pleased to offer the following: Rosettes for 1st to 4th place for All Official Classes. Trophies and Rosettes will be awarded for Best of Breed, Best of Opposite Sex, Best Puppy, Best of Winners (Rosette only), Winners Dog, Winners Bitch, Reserve Winners Dog, Reserve Winners Bitch, Veteran Dog (Rosette only), Veteran Bitch (Rosette only), For all Combined Breeds – Best Setter in Multiple Breed Specialty, Best Setter Puppy in Multiple Breed Specialty, Best Setter Veteran in Multiple Breed Specialty, Field Dog, Stud Dog, Brood Bitch & Brace. **Award Of Merit:** One rosette will be offered for every ten dogs competing at Best of Breed level. Awards of merit will be presented at the discretion of the judge.

Obedience Highest Qualifying Score by a Setter in Obedience on the day of the Specialty.

Perpetual Trophies

The following perpetual trophies will be awarded but will remain with the hosting club:

The Killane Rogue Memorial Trophy, Best Setter in Specialty - Donated by the late John & Muriel Royston.

The Spruce Trophy, BOB – English Setter –Donated by Joan Detmold

The Gunnstalk Trophy, BOB – Gordon Setter –Donated by Sandy Gunn

The Bryjade Trophy, BOB – Irish Setter –Donated by Don & Janice Craig

The Irish R & W Setter Trophy, BOB – Irish R & W Setter –Donated by the Irish R & W Setter Club of Canada

The Gus Polley Memorial Trophy, Best Puppy in Specialty –Donated by Tina Cockram, Lori Stewart & Jill Taylor

The Horace S. Hollands Memorial Trophy, Best Puppy in Sweeps - Donated by the Late Mrs. Anne Snelling

The Veteran Sweepstakes Trophy, Best Veteran in Sweeps –Donated by Len & Cheryl Walker

SWEEPSTAKES

Please Note: All Setters entered in Sweepstakes must be entered in one of the official classes or Exhibition only at the specialty.

This specialty will include Sweepstakes, Veteran Sweepstakes as follows: for All Setter Breeds

All Regular Sweepstakes classes NOT divided by sex - 6 - 9 mos, 9 -12 mos, 12 – 15 mos & 15 -18 Mos.

All Veteran Sweepstakes classes NOT divided by sex - 7-10 yrs, 10 years and over, as of the day of the specialty.

Prizes: SWEEPSTAKES & VETERAN SWEEPSTAKES

Rosettes 1st to 4th place in each class. - A rosette will be offered to the Best in Sweepstakes.

Prize money: 75% of the entry money received will be divided by the total number of entries and awarded to the winner of each of the classes based on the number of dogs entered in that class.

No additional money will be awarded to the Best in Sweepstakes.- Balance of 25% will be retained for Administration.

For More information regarding the OVASA Specialty

Wendy Watson - wwbirdie1@gmail.com **OR**

Bill Cockburn - devonshire.englishsetters@gmail.com

Regional SPECIALTY SHOW
**GERMAN SHORTHAIRED POINTER
CLUB OF CANADA**
Saturday, August 25, 2012



CONFORMATION - Regular & Non-Regular Classes

Dr. Francisco Chapa, 4a Vidriera 1505 Ote ,Col Cantu,Monterrey, N.L., MEXICO 64550

SWEEPSTAKES – All Sweepstakes Classes

Lynda Torrence

OFFICERS

President	Maxine Moinier	Vice - President	Tammy Parris
Treasurer	Barbara Taws	Secretary	Maria Foster
Directors:	Nancibeth Koutstaal (ON)		
Show Chair	Heather Brennan, nuthatchkennels@gmail.com		
Show Superintendent	Jodie O'Meara	Show Secretary	COLMAR Show Service

CLASSES - Divided by Sex

Regular Classes: Junior (6-9), Senior (9-12), (12-18), Canadian Bred, Bred By Exhibitor, Open, Veteran, Specials Only, and Exhibition Only.

NON-REGULAR CLASSES: Field Dog*, Field Bitch*, Stud Dog and Brood Bitch (Spayed or neutered Dogs may compete.)

*Field Dog & Field Bitch Class: for all German Shorthaired Pointers who have earned a Qualifying Score at a Licensed CKC Field Dog Test (Canada) or at a Licensed AKC Hunting Test (USA), or a placement at a Licensed CKC Field Trial (Canada) or at a Licensed AKC Field Trial (USA), prior to the closing of entries

Note: Dogs entered for the unofficial classes must also be entered in one of the official classes or Exhibition Only. If entered in unofficial classes, spayed/neutered dogs must be entered in exhibition only.

Trophies & Rosettes

Through the generosity of friends and members, the German Shorthaired Pointer Club Of Canada will offer suitable rosettes &/or trophies for: Best Of Breed, Best Of Opposite Sex, Best Puppy In Breed, Best Of Winners, Winners Male & Female, Reserve Winners Male & Female, Veteran Dog & Veteran Bitch, Best Canadian Bred in Breed, Best Bred By Exhibitor in Breed, Best Stud Dog, Best Brood Bitch, Best Field Dog & Best Field Bitch, & Award of Merit.

Award Of Merit: One rosette will be offered for every ten dogs competing at Best of Breed level. Awards of merit will be presented at the discretion of the judge.

SWEEPSTAKES

Please Note: All Dogs entered in Sweepstakes must also be entered in one of the official classes at the specialty.

This specialty will include SWEEPSTAKES, as follows:

All Regular Sweepstakes classes divided by sex - 6 - 9 Mths, 9 -12 Mths, & 12 -18 Mths, as of the day of the specialty.

Prizes: SWEEPSTAKES

1st in each class - 50% of entry fees in that class

15 % of all entries, will be awarded for Best in Sweepstakes.

10 % of all entries, will be awarded for Best Opposite Sex in Sweeps.

Rosettes will be awarded for 2nd through 4th placements in each class.

Balance of 25% will be retained for Administration

SPECIALTY SHOW
Standard Schnauzer Club of Canada
Saturday August 25, 2012

JUDGES

CONFORMATION - Regular & Non-Regular Classes

Douglas R Holloway Jr., 2131 Pleasant Valley Rd., Newark, DE USA 19702- 2103

SWEEPSTAKES – All Sweepstakes Classes

David Swartwood, 255 Cunningham Rd., Gananoque ON K7G 2V8

OFFICERS

President	Line Champagne	Vice-President	Heather Pedersen
Treasurer.....	Ronald Lawrence	Secretary	Beth Lawrence
Prairies – Andrea Knibbs & Jill Fraser, Ontario – Mary Davies, Judith Gooch, Karen Pare,			
Quebec – Lyne Labonte, Maritimes – Line Champagne			
Show Superintendent	Jodie O’Meara	Show Secretary.....	COLMAR Show Service

CLASSES - Divided by Sex

Regular Classes: Junior (6-9), Senior (9-12), (12-18), Canadian Bred, Bred By Exhibitor, Open, Veteran, Specials Only, and Exhibition only.

Non Regular Classes: Brace, Stud Dog, Brood Bitch.

TROPHIES AND ROSETTES

Trophies and/or Rosettes are offered by the members Standard Schnauzer Club of Canada for Best Of Breed, Best Of Opposite Sex, Best Puppy In Breed, Best Canadian Bred in specialty, Best Of Winners, Winners Dog, Winners Bitch, Reserve Winners Dog, Reserve Winners Bitch, & First in each class. Rosettes will be awarded for all placements in the regular classes.

Award Of Merit: One rosette will be offered for every ten dogs competing at Best of Breed level, awards of merit will be presented at the discretion of the judge.

A Trophy and Rosette will be awarded for the Highest Qualifying scoring Standard Schnauzer of the day in the SD & G Obedience, Rally Obedience & Agility Trials on the day of the specialty.

A Rosette will be awarded for the Highest Qualifying scoring Standard Schnauzer in each class of the day in the SD & G Obedience, Rally Obedience & Agility Trials on the day of the specialty.

SWEEPSTAKES

Please Note: All Dogs entered in Sweepstakes must also be entered in one of the official classes at the specialty

This specialty will include as follows:

All classes are to be divided by sex, 6 - 9 Mths, 9 -12 Mths, & 12 -18 Mths. as of the day of the specialty.

Prizes:

A rosette will be awarded for Best in Sweepstakes & 50% , Best of opposite sex 25% of entry fees collected
Balance of 25% will be retained by for Administration.

Veteran Sweepstakes classes: (Divided by Sex), 7-10 years, 10 years +.

A rosette will be awarded for Best in Sweepstakes & 50% , Best of opposite sex 25% of entry fees collected
Balance of 25% will be retained by for Administration.

BBQ
Saturday Night

2012 SPECIALTY - HOST HOTEL

Comfort Inn - 1625 Vincent Massey Drive , Cornwall, ON, K6H 5R6

Reservations: direct: (613) 937-0111 or 1-800-424-6423 Rate is \$ 109.50 CDN plus taxes per night
\$ 20.00 pet fee – Limit 2 dogs per room rooms held until August 1st, 2012

Please phone the hotel directly to make reservations. Tell them you are booking a room under the group “Std Schnauzer Specialty”.

For more information about the Standard Schanauzer Club of Canada Specialty, contact

Karen Pare, karenpare@xplornet.com 613-359-9975

or Michelle Ross, tealwood@sympatico.ca 905-854-1966

Rideau Terrier Club Saturday, August 25, 2012

43rd ANNUAL SPECIALTY SHOW - for All Breeds in Group 4

**THE RIDEAU TERRIER CLUB DEDICATES OUR 2012 SHOW
TO OUR FRIEND, CHRIS RAINE IN APPRECIATION OF HIS
25 YEARS AS OUR RING STEWARD**



Judge CONFORMATION - Regular Non-Regular Classes

Betty-Anne Stenmark, 12970 Skyline Blvd., Woodside, CA USA 94062-4559

Judge SWEEPSTAKES – All Sweepstakes Classes

Ed Greer, 193 Barrie Street Thornton, Ontario, L0L 2N0

Regular Classes - Divided by Sex (Spayed/neutered dogs may be entered in Veteran class)

Jr (6-9), Sr (9-12), 12 to 18 mos, Canadian Bred, Bred By Exhibitor, Open, Veteran, Specials Only, & Altered.

Non – Regular Classes: Exhibition Only, Brace & Team

The Rideau Terrier Club's BREED OF DISTINCTION FOR 2012 – Wire Fox Terrier

CLUB OFFICERS

President.....Doreen Linkletter
Vice-President.....Anita Roy
TreasurerSquibs Mercier
SecretaryBelle Severn

Show Superintendent.....Jodie O'Meara

SHOW COMMITTEE

Show ChairKaren Nesbitt
Assistant Show ChairLaura Grieveson
Trophy Chair.....Terry Cornforth
Hospitality..... Linda and Jim Mabey
Hon. Ring StewardChris Raine
Show Secretary - COLMAR Show Service

**The Rideau Terrier Club will donate \$1 per dog entered in the Specialty
towards the fight against Breed Specific Legislation**

\$50.00 Armband Draw – Donated by Belle Severn

AWARDS

Through the kindness of the Cairn Terrier Breeders and Owners the following prizes will be awarded for Cairn Terriers, Best Puppy, Winners Dog, Winners Bitch, Best of Winners, Best of Opposite Sex, Best of Breed.

The Rideau Terrier Club retains its perpetual trophies; keeper prizes are offered to the winners. All donors to the trophy fund will be listed in the Official Show Catalogue.

Best In Specialty – Betty Hyslop Memorial Trophy

Best Puppy in Specialty – Fred Fraser Memorial Trophy

Best Cdn.-bred in Specialty – Ch Redletter Miss Splinter's Memorial Trophy

Best Bred-by-Exhibitor in Specialty (Chosen from the Bred By Class) - Frances Atkins Memorial Trophy

Best Altered Dog in Specialty – Morgan Wueri Trophy

Best Veteran in Specialty – Staffhaven Trophy

Best Canadian-bred in Sweepstakes – Audrey Faibish Memorial Trophy

Best of Breed - Cairn Terrier, Cairndania Commemorative Trophy

Prizes & Rosettes – Breed level – Winners Dog & Bitch, Best of Winners, Best of Breed, Best of Opposite Sex, Best Veteran, Best Puppy, Best Altered

Prizes & Rosettes – Group level – Best in Specialty, Group 2ND, 3RD, 4TH, Best Canadian Bred, Best Puppy, Best Bred-by-Exhibitor, Best Veteran, Best Altered, Best Brace & Best Team

SWEEPSTAKES

(All Dogs entered in Sweepstakes must also be entered in one of the Regular Classes at the Specialty.)

Classes are divided by sex – Junior 6-9 mos., Senior 9-12 mos., & 12-18 mos. on the day of the Specialty.

Prizes – 1ST – 25%; 2ND – 20%, 3RD – 15%, 4TH – 10% of entry fees in class.

Best in Sweeps – 20% of total entry fees, a prize and rosette

Best of Opposite Sex in Sweeps – 10% of total entry fees, a prize and rosette

Best Canadian Bred in Sweeps – (Perpetual Trophy), a prize and rosette

Flat ribbons will be awarded for 1ST through 4TH place in each class.

Balance of 0% will be retained by the Rideau Terrier Club

JUNIOR HANDLING will be offered– Judge: Sophie Cairns

Junior Handling will be held during the Lunch Break approx Noon

Dogs Handled must be entered in the RTC Specialty Show.

All Juniors should register with the Show Secretary one hour before competition.

Trophies for Best Overall & Reserve Junior donated by Squibs Mercier.

Flats for 1st to 4th in each class, and a Rosette & Prize for Best Junior Handler & Reserve Junior Handler overall

For More information Contact - Karen Nesbitt - knesbitt@kos.net

VIZSLA Canada INC
NATIONAL SPECIALTY SHOW FOR VIZSLAS (Smooth)
Saturday, August 25, 2012

CONFORMATION - Regular & Non-Regular Classes

Janet Lobb, 51 County Road 3E, Brucefield, ON N0M 1J0



SWEEPSTAKES – All Sweepstakes Classes

Jocelyn Paul, 20 René, St-Jean-sur-Richelieu, QC J2X 5S8

OFFICERS

President	Linda Currie	Vice-President.....	Jayne Coneybear
Treasurer	Mabel Bingley	Correspondence Secretary	Billie Velestuk
Recording Secretary	Bev Lawson		

Directors:

BC –Heidi Bray, Quebec - Jacqueline Veillette, Atlantic - Richard Stoveld, Ontario – Julie Donnell
Show Chair – Terri Corneil

Show SuperintendentJodie O'Meara Show Secretary COLMAR Show Service

Regular Classes - (divided by sex) - Baby Puppy 3-6 mos, Jr Puppy 6- 9 mos, Sr Puppy 9- 12 mos, 12-18 Month, Canadian Bred, Bred by Exhibitor, Open, Specials Only , Veterans (open to all dogs over 7 years of age and older on the day of the Specialty) & Sexually Altered Class

Non-Regular Classes - Exhibition Only, Brace Class, Stud Dog & Get – Brood Bitch & Progeny

Unofficial Classes (divided by sex) - Field Dog & Field Bitch (Must have any Field Title from CKC, AKC, NASTRA, NAVHDA)

TROPHIES AND ROSETTES

Trophies and/or Rosettes are offered by Vizsla Canada for Best of Breed, Best of Opposite Sex, Best of Winners, Best Puppy, Best Baby Puppy, Winners Dog & Bitch, Reserve Winners Dog & Bitch, Best Altered in Breed, Altered Dog & Bitch, Stud Dog, Brood Bitch, Best Brace, Field Dog, Field Bitch, Best Canadian Bred in Specialty (not necessarily from the Cdn Bred Class), 1st in each class.

Rosettes for 2nd through 4th in each class

Award Of Merit: One rosette will be offered for every ten dogs competing at Best of Breed level. Awards of Merit will be presented at the discretion of the judge.

Trophies & Rosettes will be given for the Highest Qualifying Score for a Vizsla in the SD& G all breed trials in Obedience, Rally and Agility when entered in the trials being held on the day of the Specialty.

SWEEPSTAKES

All Dogs entered in Sweepstakes must also be entered in one of the regular classes or exhibition only at the specialty.

Sweepstakes classes (divided by sex) - 6 - 9 Mos, 9 -12 Mos, & 12 -18 Mos

Trophy & Rosette for Best in Sweepstakes, Best of Opposite in Sweepstakes, & Best Puppy in Sweeps

VETERANS SWEEPSTAKES

All Dogs entered in Veteran Sweepstakes must be entered the regular classes or exhibition only at the specialty
Classes, divided by sex are offered for dogs 7 years & older.

Trophy and Rosette for Best in Veteran Sweepstakes and Best of Opposite in Veteran Sweepstakes.

SWEEPSTAKE PRIZES:

Entry fee in each class for both sweepstakes will be divided: 1st – 40%, 2nd – 30%, 3rd – 20%, 4th – 10%
25% of entry money will be retained by SD & G DA for administration costs in both sweepstakes

Professional handlers may only handle dogs they own or co-own in both Sweepstakes. Professional handler is any person who has ever accepted remuneration for handling any breed of dog in the show ring.

2012 Specialty– Host Hotel

Comfort Inn – 1625 Vincent Massey Drive, Cornwall, ON, K6H 5R6

Reservations: direct (613) 937-0111 or 1-800-424-6423 Rate is \$105.00 CDN plus taxes per night

No fee for dogs. Please phone the hotel directly to make reservations.

Tell them you are booking a room under the group “Vizsla Canada Specialty”

Rooms held until August 1st, 2012

All Vizsla Canada Specialty exhibitors and their families are invited to join us for a light luncheon hosted by Vizsla Canada.

For More information regarding this specialty **Contact**
Terri Corneil, tcorneil@shaw.ca



Specialty Show

**Border Terrier Club Of Ontario
Sunday August 26, 2012**



CONFORMATION - Regular & Non-Regular Classes

Tinna Grubbe, Ågerupvej 92, DK-4390 Vipperød (Denmark)

SWEEPSTAKES - Regular & Veteran Sweepstakes Classes

Linda Hough, Box 387, Sharon, Ontario, LOG 1V0

OFFICERS

PresidentPat Dimitrovski Vice-PresidentKirsten Goodman
Secretary/TreasurerKaren Nesbitt
Show Chairperson.....Karen Nesbitt
Show SuperintendentJodie O'Meara Show Secretary COLMAR Show Service

CLASSES - Divided by Sex

Regular Classes: Baby Puppy (3 – 6), Junior (6-9), Senior (9-12), (12-18), Canadian Bred, Bred By Exhibitor, Open, Veteran, Specials Only.

Non- Regular Classes: Exhibition only, Stud Dog, Brood Bitch,

UNOFFICIAL CLASSES: Working Terrier (for any Border Terrier, either sex, who has attained any CKC Working Title, American Working Terrier Association, (CKC recognized) certificate of Gameness, or an American Kennel Club Junior Earthdog, Senior Earthdog or Master Earthdog title. Spayed or neutered animals may compete. Award for first in class only.)

Note: Dogs entered for the unofficial classes must also be entered in one of the official classes or Exhibition Only. If entered in Unofficial classes, spayed/neutered dogs must be entered in exhibition only.

PRIZES

Through the generosity of members and friends, Prizes and/or Rosettes will be awarded for Best Of Breed, Best Of Opposite, Best Baby Puppy in Breed, Best Puppy, Winners Dog, Winners Bitch, Best Of Winners, Veteran Dog & Bitch, Working Dog & Bitch, Stud Dog, Brood Bitch, awards for Best Otter Head, Best Bred by Exhibitor in Specialty. In addition, an award will be offered for all Border Terriers receiving a qualifying score in any of the SD & G Obedience, Rally, or Agility trials on the day of the specialty.

The prize for Best Otter Head will be awarded jointly by the Breed and Sweepstakes Judges

AWARD OF MERIT: One Rosette will be offered for every ten dogs entering the Best of Breed ring. Award of Merit will be presented at the discretion of the Judge

Perpetual Trophies

Best in Specialty Perpetual Trophy "BOB" – Given in memory of our friend Barbara Wilson

The Elaine Marshall Perpetual Trophy for Best in Regular (Puppy) Sweepstakes

Russethill Trophy for Best Bred By Exhibitor in Specialty.

SWEEPSTAKES

Please Note: All Dogs entered in Sweepstakes must also be entered in one of the official classes at the specialty.

This specialty will include SWEEPSTAKES, VETERAN SWEEPSTAKES as follows:

All Regular Sweepstakes classes divided by sex - 6 - 9 Mos, 9 -12 Mos, & 12 -18 Mos, as of the day of the specialty.

All Veteran Sweepstakes classes are to be divided by sex - 7-years and over, as of the day of the specialty.

Prizes: SWEEPSTAKES & VETERAN SWEEPSTAKES

40 % of all entries, & Rosette, will be awarded for Best in Sweeps & for BOS in Sweeps.

Flat ribbons will be awarded for 2nd to 4th placements in each class. Balance of 20% will be retained for Administration

THE BORDER TERRIER CLUB OF ONTARIO BBQ DINNER

Sun. August 26/12, hosted by The Border Terrier Club of Ontario.

A BBQ steak dinner will be held on site at 5:00 pm at a cost of \$35 per person.

please contact Pat Dimitrovski at patdimitrovski@hotmail.com to reserve .

SILENT AUCTION -- There will be a Silent Auction hosted by The Border Terrier Club of Ontario.

Please notify Susan Rome at P.O. Box 114, Sutton, ON, L0E 1R0 or email brian.rome@rogers.com of your donation and bring it along on Sunday, August 26, 2012

"BORDER BITS"- All Border Terriers attending the Stormont, Dundas and Glengarry shows are

invited to join us at 4 pm on Sunday, August 26 for pre-dinner hospitality and this fun and educational event. This will be a "hands on" event that encourages all attending to join in the judging, assessing these distinctive traits that help to define our breed type. Enter your dog for Best Carrot Tail, Best Teeth and Bite, Best Rib or Best Hide and Coat".

Entered on the day. Prizes will be awarded to the winner in each of the four categories.

For More information Contact - Karen Nesbitt - knesbitt@kos.net

Ottawa Valley Pointing Dog Club

SPECIALTY SHOW for

Kleiner Munsterlander Vorstehund, Braque Français, Wire-Haired Pointing Griffon, Pointer, Pointer (GLH, GSH, GWH), Pudelpointer, Setter (Irish, English, Gordon, Irish R & W), Spaniel (Blue Picardy, Brittany, French), Spinone Italiano, Vizsla (SM & WH), Weimaraner

Sunday, August 26, 2012

CONFORMATION - Regular & Non-Regular Classes

Betty - Anne Stenmark

12970 Skyline Blvd., Woodside, CA USA 94062-4559

SWEEPSTAKES – All Sweepstakes Classes

Diane Solman, Box 550 North Gower, ON K0A 2T0



PROUDLY SPONSORED BY



OFFICERS

President	Kerry McGonegal	Vice-President	Eric Beere
Treasurer	Deborah Cook	Secretary	Gail Docherty
Field Director	Kevin MacWilliams	Hospitality	OVPDC Members
Show Chair	Gail Docherty/ Deborah Cook		
Show Superintendent	Jodie O'Meara	Show Secretary	COLMAR Show Service

CLASSES - Divided by Sex

Regular Classes: Junior (6-9), Senior (9-12), (12-18), Canadian Bred, Bred By Exhibitor, Open, Veteran, Specials Only.

Non – Regular Classes: Exhibition Only, Field Dog*.

*Entries in Field Class may be spayed or neutered & must be entered in any OVPDC Specialty class or Exhibition Only

***The Field Dog class will be judged after Best of Breed for each breed**

TROPHIES AND ROSETTES

The following Ribbons, Rosettes and Trophies have been made possible by the generosity of members and friends of the Ottawa Valley Pointing Dog Club and by Eukanuba:

Ribbons will be awarded 1st thru 4th Place and to Winners Dog & Bitch in all Regular Classes

Rosettes will be awarded:

In each breed for Best of Breed; Best of Opposite Sex; Best of Winners, Best Veteran, Best Puppy; and Best Field Dog

To Best in Multiple Breed Specialty (MBS); Best Puppy in MBS; Best Veteran in MBS; Best Field Dog in MBS

Highest qualifying score in Obedience by a pointing breed, on each of Saturday and Sunday with host club obedience trials

Highest qualifying score in Rally by a pointing breed, on each of Saturday and Sunday with host club obedience trials

Highest cumulative daily score in agility by a pointing breed, on each of Saturday and Sunday at host club agility trials

Trophies will be awarded:

To Best in Multiple Breed Specialty (MBS); Best Puppy in MBS; Best Veteran in MBS; Best Field Dog in MBS; Best of Breed; Best Field Dog in Breed; Highest qualifying score in Obedience, by a pointing breed during 2 days (Saturday/Sunday); Highest qualifying score in Rally, by a pointing breed during 2 days (Saturday/Sunday); Highest qualifying score in obedience, by a German Short-Haired Pointer during 2 days (Saturday/Sunday); Highest Cumulative 2 day (Saturday/Sunday) Score in agility, by a pointing breed.

Three Ottawa Valley Pointing Dog Club Versatility Awards.

- (1) Open to all Pointing Breeds (must not be entered in CKC field test)
- (2) Open to all German Short-Haired Pointers (must be entered in CKC field test)
- (3) Open to all Pointing Breeds (must be entered in CKC field test)

(Continued on next page.....)

(.....Continued from the previous page)

Perpetual Trophies and Awards

The following perpetual trophies will be awarded but will remain with the hosting club:

- Best in Multiple-Breed Specialty
- Best Puppy in Multiple-Breed Specialty
- Best Veteran in Multiple-Breed Specialty
- Best Field Dog in Multiple-Breed Specialty
- Best in Sweepstakes – Puppy and Veteran
- Highest Qualifying Score in Obedience (all Pointing Breeds competing)
- Highest Qualifying Score for a German Short-Haired Pointer in Obedience
- Highest Qualifying Score in Rally (All Pointing Breeds Competing)
- Highest Cumulative Score in Agility (all Pointing Breeds competing)
- Highest Qualifying Score in the Hunt Test (all Pointing Breeds competing)
- The OVPD Club Versatility Award (All Pointing Breeds Competing)
- The OVPD Club Versatility Award (German Short-Haired Pointer)
- The OVPD Club Versatility Award – Field- (all Pointing Breeds competing)

Unofficial classes

- Best Field Dog in Breed*
 - Best-in-Multiple Breed Specialty (Best in each breed to compete)
 - Best Puppy in Multiple Breed Specialty (Best Puppy in each breed to compete)
 - Best Veteran in Multiple Breed Specialty (Best Veteran in each breed to compete)
 - Best Field Dog in Multiple Breed Specialty (Best Field Dog in each breed to compete)
- * Must have at least 1 confirmed qualifying score in a CKC or AKC hunting event, and must also enter Regular Specialty Classes or Exhibition Only (Veteran & Exhibition entries may be spayed/neutered)

Sweepstakes

- Sweepstakes* – Not divided by Sex or Breed, (6 to 9 months, 9 to 12 months, 12-18 months)
- Veterans* Sweepstakes - Not divided by Sex or Breed, (7-10 years, over 10 years)
- (Veterans may be spayed or Neutered)
- Breeds & sexes will be judged together

* Must also enter Regular Specialty Classes or Exhibition Only

Prizes for Sweepstakes and Veteran Sweepstakes: Prize money to be divided as follows:

75% of the entry money received will be divided by the total number of entries and awarded to the winner of each of the classes based on the number of dogs entered in that class.

No additional money will be awarded to the Best in Sweepstakes.

The remaining 25% of the entry fee will be retained to defray expenses.

Best in Sweepstakes, & Best Veteran in Veteran Sweepstakes

Special Events

All OVPDC members, friends and exhibitors are invited to ringside for refreshments on the day of the specialty.

Booster: (All Pointing Breeds) Saturday, August 25, 2012

Obedience Competition (Saturday & Sunday, with Host Show)

Rally Competition (Saturday & Sunday, with Host Show)

Agility Competition (Saturday & Sunday with Host Show)

CKC Field Test nearby (Tuesday August 28, 2012)

3 OVPDC Versatility Awards - (awarded at Field event Tuesday August 28, 2012)

Junior Handling

JUNIOR HANDLING will be offered – Judge: TBA, Time during the lunch break

All Juniors should register with the Show Secretary

one hour before competition.

Flats for 1st to 4th in each class, and a Rosette & Prize for Best Junior Handler & Reserve Junior

Handler overall Junior Handlers - each 1st place winner will receive a prize from "Eukanuba"



Please visit www.ovpdc.org

PROUDLY SPONSORED BY
Eukanuba

<input type="checkbox"/> Club Barbet Canada - Saturday August 25, 2012	SD & G Specialties	Armband # _____
<input type="checkbox"/> Canadian Bloodhound Club - Saturday August 25, 2012	<input type="checkbox"/> Nova Scotia Duck Tolling Ret CC - Aug 25, 2012	
<input type="checkbox"/> Dalmatian Club of Canada - Saturday August 25, 2012	<input type="checkbox"/> Vizsla Canada - Sat Aug 25, 2012	
<input type="checkbox"/> Ottawa Valley All Setter Association- Saturday Aug 25/12	<input type="checkbox"/> Border Terrier Club of ON - Sunday August 26, 2012	
<input type="checkbox"/> Pointer Club of Canada National - Sat August 25, 2012	<input type="checkbox"/> English Setter Club of Canada - Sunday August 26, 2012	
<input type="checkbox"/> German Shorthaired Pointer CC - Sat Aug 25, 2012	<input type="checkbox"/> English Springer Spaniel CC- Sunday August 26, 2012	
<input type="checkbox"/> Rideau Terrier Club - Group Four Specialty- Sat Aug 25/12	<input type="checkbox"/> Ottawa Valley Pointing Dog Club - Sunday August 26, 2012	
<input type="checkbox"/> Standard Schnauzer Club of Canada - Sat August 25, 2012	<input type="checkbox"/> Miniature Schnauzer - RTC -Sunday. August 26, 2012	
<input type="checkbox"/> Norfolk Terrier Club of Canada - Sat August 25, 2012	<input type="checkbox"/> Wire Fox Terrier CC National - Sun August 26, 2012	
 Price List - Entry Fee: \$ 29.00 CDN/USD Listing Fee: \$ 9.55 & Baby Puppy 2.00 CDN/USD  Other Fees: Exhibition, Sweepstakes, Non Regular, \$15.00 CDN/USD		
PRE - ORDERED CATALOGUES - <input type="checkbox"/> ALL BREED \$8.00 CDN/USD		
Please Make ALL Cheques Payable to SD & G Dog Association Inc Entries Close: Tuesday JULY 31, 2012 at 8pm		
CONFORMATION		
<input type="checkbox"/> BABY. Puppy (3-6 mth)	<input type="checkbox"/> 12 - 18 months	<input type="checkbox"/> Canadian Bred
<input type="checkbox"/> Jr. Puppy (6 - 9 mth)	<input type="checkbox"/> 12 - 15 months	<input type="checkbox"/> Bred By Exhibitor
<input type="checkbox"/> SR. Puppy (9 - 12 mth)	<input type="checkbox"/> 15 - 18 months	<input type="checkbox"/> Open
		<input type="checkbox"/> Specials Only
		<input type="checkbox"/> Veteran
		<input type="checkbox"/> Sexually Altered
SWEEPSTAKES		
<input type="checkbox"/> 6 - 9 MONTHS	<input type="checkbox"/> 15-18 months	<input type="checkbox"/> 7-9 years
<input type="checkbox"/> 9 - 12 months	<input type="checkbox"/> 12-18 months	<input type="checkbox"/> 7 -10 years
<input type="checkbox"/> 12-15 months	<input type="checkbox"/> 18 - 24 months	<input type="checkbox"/> 9 -11 years
		<input type="checkbox"/> 9 years +
		<input type="checkbox"/> 10 years +
		<input type="checkbox"/> 11 years +
		<input type="checkbox"/> 11-12 years
		<input type="checkbox"/> 13 years +
		<input type="checkbox"/> 3 Generation Sweepstakes
SPECIALTY OBEDIENCE		
<input type="checkbox"/> Pre- Novice	<input type="checkbox"/> Novice A	<input type="checkbox"/> Novice B
<input type="checkbox"/> Novice C	<input type="checkbox"/> Open A	<input type="checkbox"/> Open B
<input type="checkbox"/> Utility A	<input type="checkbox"/> Utility B	
<input type="checkbox"/> Intermediate Novice	JUMP HEIGHTS Height - _____	Width - _____
NON REGULAR CLASSES		
<input type="checkbox"/> Exhibition Only	<input type="checkbox"/> Brace	<input type="checkbox"/> Brood Bitch
<input type="checkbox"/> Stud Dog	<input type="checkbox"/> Parade of Veterans	<input type="checkbox"/> Parade of Titleholders
<input type="checkbox"/> Field Dog	<input type="checkbox"/>	<input type="checkbox"/>
ANY OTHER CLASS NOT LISTED <input type="checkbox"/>		
BREED	<input type="checkbox"/> Short - Haired	SEX: <input type="checkbox"/> MALE OR <input type="checkbox"/> FEMALE
	<input type="checkbox"/> Long - Haired	
REGISTERED NAME OF DOG		
Check One & Enter Number Here	Date Of Birth: Please Circle Month	IS THIS A PUPPY?
<input type="checkbox"/> CKC Reg #	Jan Feb Mar Apr May June	<input type="checkbox"/> Yes or <input type="checkbox"/> No
<input type="checkbox"/> CKC PEN #	July Aug Sept Oct Nov Dec	PLACE OF BIRTH?
<input type="checkbox"/> CKC ERN #	Day _____ Year _____	<input type="checkbox"/> Canada
<input type="checkbox"/> CKC Misc Cert.#		<input type="checkbox"/> Elsewhere
<input type="checkbox"/> LISTED		
BREEDER(S)		
SIRE		
DAM		
REGISTERED OWNER(S)		
OWNER'S ADDRESS		
CITY	PROV/STATE	POSTAL CODE/ZIP
NAME OF OWNERS AGENT (IF ANY) AT THE SHOW		
AGENT'S ADDRESS		
CITY	PROV/STATE	POSTAL CODE/ZIP
Mail ID to: <input type="checkbox"/> OWNER Or <input type="checkbox"/> AGENT		
<small>I certify that I am the registered Owner(s) of the dog or that I am the authorized agent of the Owner(s) whose name(s) I have entered above and accept full responsibility for all statements made in this entry. In consideration of the acceptance of this entry, I (we) agree to be bound by the rules and regulations of the Canadian Kennel Club and any additional rules and regulations appearing in the premium list. Also, by signing this form I certify that I will not hold the Show giving Club, it's members, Directors, Employees, or Agents, liable in the event of any accident or misfortune however caused.</small>		
Signature of Agent or Owner _____		Phone Number _____
a 15% + HST, charge applies on all Credit Card Charges		Email address _____
<input type="checkbox"/> VISA	<input type="checkbox"/> MasterCard	<input type="checkbox"/> AMEX
Expiry Date: Month > _____ Year > _____		
Card Number: _____ - _____ - _____ - _____		
Name of Card Holder: _____		
Fax # 519-351-3223	Mail To: COLMAR Show Service, Web Site: www.colmars.com	In Canada: 340 Mercer St, Chatham, ON. Canada N7M 6E1 In USA: PO Box 142, Marine City, MI. USA 48039-0142

**SPECIALTY SHOW
FOR MINIATURE SCHNAUZERS ONLY**

Sponsored by Rideau Terrier Club - **Sunday, August 26, 2012**

CONFORMATION - Regular Non-Regular Classes

Dr. Francisco Chapa, 4a Vidriera 1505 Ote ,Col Cantu,Monterrey, N.L., MEXICO 64550

CLUB OFFICERS

President.....Doreen Linkletter
Vice-President.....Anita Roy
TreasurerSquibs Mercier
SecretaryBelle Severn

SHOW COMMITTEE

Show ChairJodie O'Meara
Show Superintendent.....Jodie O'Meara
Show Secretary - COLMAR Show Service

Regular Classes - Divided by Sex (Spayed/neutered dogs may be entered in Veteran class)

Jr (6-9), Sr (9-12), 12 to 18 months, Canadian Bred, Bred By Exhibitor, Open, Veteran, Specials Only.

Non – Regular Classes: Exhibition Only,

AWARDS

Prizes and Rosette will be awarded to, Best of Breed, Best of Opposite, Best Puppy, Best Veteran
Winners Dog, and Bitch, Best of Winners, Reserve Winners Dog, and Bitch.

For More information Contact - Karen Nesbitt - knesbitt@kos.net

**National Specialty Show
WIRE FOX TERRIER CLUB OF CANADA
Sunday, August 26, 2012**



CONFORMATION - Regular Non-Regular Classes

Tinna Grubbe, Ågerupvej 92, DK-4390 Vipperød (Denmark)

CLUB OFFICERS

President.....Darle Heck
Vice-President.....Barbara Watt
Treasurer/Secretary Elizabeth Campbell

SHOW COMMITTEE

Show ChairJodie O'Meara
Show Superintendent.....Jodie O'Meara
Show Secretary - COLMAR Show Service

Directors: **BC-** Alexis Davidson, **Prairies** - Judy McVeigh, **ON** - Colin Gerrard, **PQ** - Jacques Charron

Regular Classes - Divided by Sex (Spayed/neutered dogs may be entered in Veteran class)

Jr (6-9), Sr (9-12), 12 to 18 months, Canadian Bred, Bred By Exhibitor, Open, Veteran, Specials Only.

Non – Regular Classes: Exhibition Only,

AWARDS

Prizes and Rosette will be awarded to, Best of Breed, Best of Opposite, Best Puppy, Best Veteran
Winners Dog, and Bitch, Best of Winners, Reserve Winners Dog, and Bitch.

Perpetual Trophies

Best of Breed: The Marksman Trophy
Best of Winners: Hugh Brown Memorial Trophy
Winners Dog: Kathy Ferguson Memorial Trophy
Winners Bitch: Elfie Erzberger Memorial Trophy
Best Puppy: Dimminsdale Trophy

Wire Fox Terrier Club of Canada retains its perpetual trophies; keeper prizes are offered to the winners.

For More information Contact

Colin Gerrard - Ontario Director WFTCC

bridgedalewires@gmail.com

416 – 893 - 7515

<input type="checkbox"/> Club Barbet Canada - Saturday August 25, 2012	SD & G Specialties	Armband # _____
<input type="checkbox"/> Canadian Bloodhound Club - Saturday August 25, 2012	<input type="checkbox"/> Nova Scotia Duck Tolling Ret CC - Aug 25, 2012	
<input type="checkbox"/> Dalmatian Club of Canada - Saturday August 25, 2012	<input type="checkbox"/> Vizsla Canada - Sat Aug 25, 2012	
<input type="checkbox"/> Ottawa Valley All Setter Association- Saturday Aug 25/12	<input type="checkbox"/> Border Terrier Club of ON - Sunday August 26, 2012	
<input type="checkbox"/> Pointer Club of Canada National - Sat August 25, 2012	<input type="checkbox"/> English Setter Club of Canada - Sunday August 26, 2012	
<input type="checkbox"/> German Shorthaired Pointer CC - Sat Aug 25, 2012	<input type="checkbox"/> English Springer Spaniel CC- Sunday August 26, 2012	
<input type="checkbox"/> Rideau Terrier Club - Group Four Specialty- Sat Aug 25/12	<input type="checkbox"/> Ottawa Valley Pointing Dog Club - Sunday August 26, 2012	
<input type="checkbox"/> Standard Schnauzer Club of Canada - Sat August 25, 2012	<input type="checkbox"/> Miniature Schnauzer - RTC -Sunday. August 26, 2012	
<input type="checkbox"/> Norfolk Terrier Club of Canada - Sat August 25, 2012	<input type="checkbox"/> Wire Fox Terrier CC National - Sun August 26, 2012	
 Price List - Entry Fee: \$ 29.00 CDN/USD Listing Fee: \$ 9.55 & Baby Puppy 2.00 CDN/USD  Other Fees: Exhibition, Sweepstakes, Non Regular, \$15.00 CDN/USD		
PRE - ORDERED CATALOGUES - <input type="checkbox"/> ALL BREED \$8.00 CDN/USD		
Please Make ALL Cheques Payable to SD & G Dog Association Inc Entries Close: Tuesday JULY 31, 2012 at 8pm		
CONFORMATION		
<input type="checkbox"/> BABY. Puppy (3-6 mth)	<input type="checkbox"/> 12 - 18 months	<input type="checkbox"/> Canadian Bred
<input type="checkbox"/> JR. Puppy (6 - 9 mth)	<input type="checkbox"/> 12 - 15 months	<input type="checkbox"/> Bred By Exhibitor
<input type="checkbox"/> SR. Puppy (9 - 12 mth)	<input type="checkbox"/> 15 - 18 months	<input type="checkbox"/> Open
		<input type="checkbox"/> Specials Only
		<input type="checkbox"/> Veteran
		<input type="checkbox"/> Sexually Altered
SWEEPSTAKES		
<input type="checkbox"/> 6 - 9 MONTHS	<input type="checkbox"/> 15-18 months	<input type="checkbox"/> 7-9 years
<input type="checkbox"/> 9 - 12 months	<input type="checkbox"/> 12-18 months	<input type="checkbox"/> 7 -10 years
<input type="checkbox"/> 12-15 months	<input type="checkbox"/> 18 - 24 months	<input type="checkbox"/> 9 -11 years
		<input type="checkbox"/> 9 years +
		<input type="checkbox"/> 10 years +
		<input type="checkbox"/> 11 years +
		<input type="checkbox"/> 11-12 years
		<input type="checkbox"/> 13 years +
		<input type="checkbox"/> 3 Generation Sweepstakes
SPECIALTY OBEDIENCE		
<input type="checkbox"/> Pre- Novice	<input type="checkbox"/> Novice A	<input type="checkbox"/> Novice B
<input type="checkbox"/> Novice C	<input type="checkbox"/> Open A	<input type="checkbox"/> Open B
<input type="checkbox"/> Utility A	<input type="checkbox"/> Utility B	
<input type="checkbox"/> Intermediate Novice	JUMP HEIGHTS Height - _____	Width - _____
NON REGULAR CLASSES		
<input type="checkbox"/> Exhibition Only	<input type="checkbox"/> Brace	<input type="checkbox"/> Brood Bitch
<input type="checkbox"/> Stud Dog	<input type="checkbox"/> Parade of Veterans	<input type="checkbox"/> Parade of Titleholders
<input type="checkbox"/> Field Dog	<input type="checkbox"/>	<input type="checkbox"/>
ANY OTHER CLASS NOT LISTED <input type="checkbox"/>		
BREED	<input type="checkbox"/> Short - Haired	SEX: <input type="checkbox"/> MALE OR <input type="checkbox"/> FEMALE
	<input type="checkbox"/> Long - Haired	
REGISTERED NAME OF DOG		
Check One & Enter Number Here	Date Of Birth: Please Circle Month	IS THIS A PUPPY?
<input type="checkbox"/> CKC Reg #	Jan Feb Mar Apr May June	<input type="checkbox"/> Yes or <input type="checkbox"/> No
<input type="checkbox"/> CKC PEN #	July Aug Sept Oct Nov Dec	PLACE OF BIRTH?
<input type="checkbox"/> CKC ERN #	Day _____ Year _____	<input type="checkbox"/> Canada
<input type="checkbox"/> CKC Misc Cert.#		<input type="checkbox"/> Elsewhere
<input type="checkbox"/> LISTED		
BREEDER(S)		
SIRE		
DAM		
REGISTERED OWNER(S)		
OWNER'S ADDRESS		
CITY	PROV/STATE	POSTAL CODE/ZIP
NAME OF OWNERS AGENT (IF ANY) AT THE SHOW		
AGENT'S ADDRESS		
CITY	PROV/STATE	POSTAL CODE/ZIP
Mail ID to: <input type="checkbox"/> OWNER Or <input type="checkbox"/> AGENT		
<small>I certify that I am the registered Owner(s) of the dog or that I am the authorized agent of the Owner(s) whose name(s) I have entered above and accept full responsibility for all statements made in this entry. In consideration of the acceptance of this entry, I (we) agree to be bound by the rules and regulations of the Canadian Kennel Club and any additional rules and regulations appearing in the premium list. Also, by signing this form I certify that I will not hold the Show giving Club, it's members, Directors, Employees, or Agents, liable in the event of any accident or misfortune however caused.</small>		
Signature of Agent or Owner _____		Phone Number _____
a 15% + HST, charge applies on all Credit Card Charges		Email address _____
<input type="checkbox"/> VISA	<input type="checkbox"/> MasterCard	<input type="checkbox"/> AMEX
Expiry Date: Month > _____ Year > _____		
Card Number: _____ - _____ - _____ - _____		
Name of Card Holder: _____		
Fax # 519-351-3223	Mail To: COLMAR Show Service, Web Site: www.colmars.com	In Canada: 340 Mercer St, Chatham, ON. Canada N7M 6E1 In USA: PO Box 142, Marine City, MI. USA 48039-0142

Note: Overflow camping hydro (electric) is \$50.00 and **MUST to be pre paid** by August 16, 2012
 Please forward payment to; Jodie O'Meara,
 6135 Garlandside Rd., Cumberland, ON K4B 1S7
 For more information contact - Jeff Dale, jdale@trademarkmedia

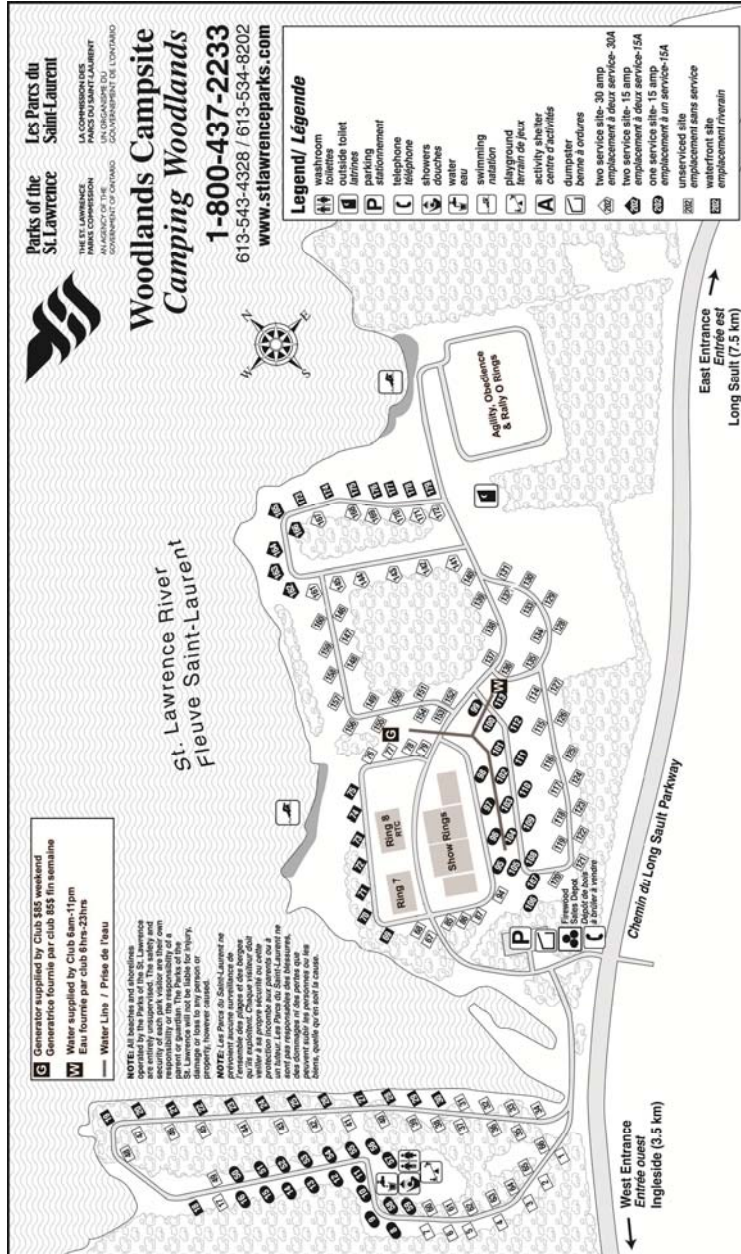

RV Trailer and Exhibitor Parking & Electrical Hook-ups

RV's & Trailers Reservations Accepted & Strongly Suggested, Please call 1-800-437-2233. Inform the Park you are with the Dog Show

There is no site sharing & visitors are not permitted to enter the park after 8pm. Limited Electrical Hook-ups. Don't be disappointed book early.

No refunds under any circumstances. Electrical - per receptacle \$ 85.00 CDN or USD. Any & All unpaid hook-ups will be removed.

All Electrical hook-ups are to be paid at the show and to SD & G. Please refer to the map for campsite you wish to reserve closest to amenities. It is your responsibility to have enough cord to reach the generator, or hose for Water Hook-up. Refer to Map for locations. Water lines are marked on map (W). SD & G or it's affiliates do not accept or assume any liability for any damages caused by removal of unpaid electrical or Water Hook-ups.

Unavailable Sites: - 71, 72, 83, 84, 88-92, 93, 95, 96, 98&, 100, 102, 103, 105-108, 109, 153-156, 154, 155, 163-166, 172

Please Contact Jeff Dale, 613-366-2030 ext # 2000 jdale@trademarkmedia.ca

ACCOMMODATIONS

The following Motels/Hotels may accept dogs. Some of them may require a deposit or room-cleaning fee. Please verify acceptance of dogs in rooms when making reservations and respect Motel/Hotel property to ensure that you will be welcomed back.

If you are planning on leaving your dogs crated in your room, please do not leave them alone. Some dogs have a tendency to voice their disapproval to this situation and to the other guests.

Eukanuba 

Best Western 1515 Vincent Massey Dr., Cornwall ON
613-932-0451

Comfort Inn 1625 Vincent Massey Dr., Cornwall ON
613-937-0111

Days Inn 1541 Vincent Massey Dr., Cornwall ON
613-937-3535

Lion Motel Hwy 32 exit # 778, Long Sault, ON
613-634-2119

Nites Inn 2120 Vincent Massey Dr., Cornwall ON
613-932-9623



DIRECTIONS TO THE SHOW SITE

(Map only as reference please refer to an official Ontario road map)

