

ELIGIBILITY & COURSE

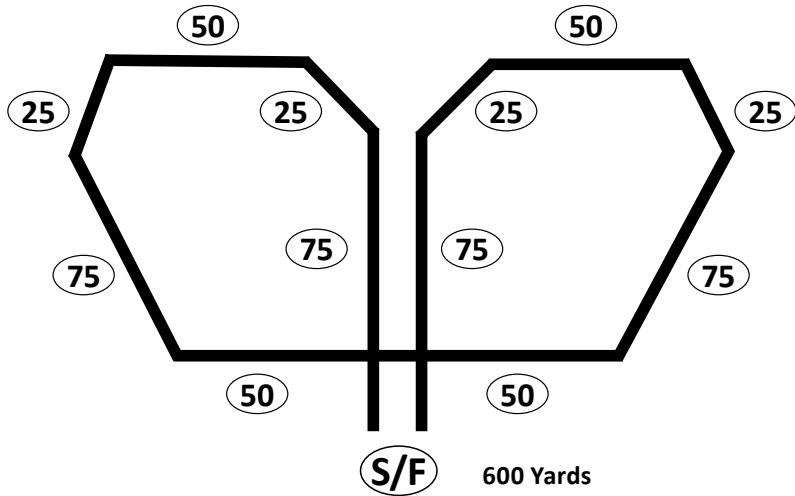

The field committee reserves the right to alter the course plan as required by weather and/or field conditions on the day of the event.

ELIGIBLE BREEDS: Chase Ability Program participation is open to all purebred and mixed-breed dogs at least 12 months of age that are individually registered with the CKC; or have an Event Registration Number (ERN); or have a Performance Event Number (PEN); or eligible for registration with the CKC; or have a Miscellaneous Certificate Number (MCN) if it belongs to a CKC listed breed; or have a Canine Companion Number (CCN) if it's a mixed breed.

Dogs with breed disqualifications are eligible to enter. Females in season may not enter. A dog may enter only once per event. Running order determined by order in which entries are received. Dogs run as singles.

300-YARD COURSE: This distance is for dogs shorter than 12 inches at the withers or brachycephalic ("flat-faced") dogs. **Dogs will run one loop.**

600-YARD COURSE: This distance is used for all dogs that do not run the 300 yard course. Dogs will run both loops.

If there is a question as to which course a dog will run the judge will decide.

RIBBONS: Gold qualifying ribbons will be awarded to dogs passing their test.

EXHIBITORS PLEASE NOTE: It shall be the duty and obligation of the trial-giving club to see that a judge, club official, volunteer, or any participant at an event held under these rules is not subject to any indignities of any kind. The Field Trial Committee Chair shall promptly report to the CKC any infringement of this regulation, and the Discipline Committee shall have the authority to take such action as it deems fit on receipt of a report indicating that this has occurred.

OFFICIAL PREMIUM LIST



SALUKI CLUB OF CANADA

2 CKC CHASE ABILITY EVENTS SATURDAY, JULY 30 and SUNDAY, JULY 31, 2016

TO BE HELD OUTDOORS, RAIN OR SHINE, AT
Maple Lane Farm
6311 12th Line, Alliston (New Tecumseth), ON L9R 1V4

ROLL CALL

Note: All dogs must be present for their appropriate roll-call time to be checked for lameness and bitches in season. Dogs will run in the order entries are received.

9:30 a.m. Dogs 12 inches and shorter at the withers
and/or brachycephalic (flat-faced dogs)

10:30 a.m. Dogs over 12 inches at the withers

JUDGES

Saturday, July 30, 2016

Mrs. Barbara Smith, 7156 Appleby Line, R.R. 6, Milton, ON L9T 2Y1

Sunday, July 31, 2016

Mr. Larry Gahan, 42 Todd St., Cambridge, ON N1R 1G5

ENTRIES CLOSE:

THURSDAY, JULY 28, 2016, 8 PM (EST)

ENTRY LINE ENTRIES CLOSE JULY 28, AT 4 PM (EST)

THERE WILL BE NO DAY-OF-TRIAL ENTRIES



Enter via **The Entry Line** or mail entries to:

Janice Preiss, 332 Centre St. N., Beeton, ON L0G 1A0

These events held under rules of the Canadian Kennel Club.

THERE WILL BE A LIMIT OF 75 ENTRIES ACCEPTED PER DAY.

EXECUTIVE & TRIAL COMMITTEE

President	Dee Laurie-Beaumont
Vice-President	Sandra Meret
Secretary/Treasurer.....	Patty Milton
	5066 Wellington Rd. 125, Acton, ON L7J 2L9
	k94milton@gmail.com
Past President.....	Susan Konopa
Directors	Wenche Overland, Julie Poirier, Starr White,
	Robbie Pattison, Jan Phelps
Event Chair.....	Sherri Hall
Event Superintendent.....	Janice Preiss
Event Secretary.....	Janice Preiss
	332 Centre St. N., Beeton, ON LOG 1A0
	azad1@rogers.com
Official Veterinarian.....	Veterinary Emergency Clinic
	115 Bell Farm Rd., Unit 110, Barrie, ON L4M 5G1
	Phone: 705-722-0377

FIELD COMMITTEE

Inspection Committee.....	Sandra Meret, Dee Beaumont
Hunt Masters.....	Branka Bradic, Patty Milton
Lure Operators.....	Brad Heppel, Jacob Simunovic
Field Clerks.....	Sandra Meret, Patty Milton
Paddock Masters.....	Starr White, Sandra Gahan

CANADIAN KENNEL CLUB OFFICERS

CKC Offices	Mr. Lance Novak
	200 Ronson Dr., Ste. 400, Etobicoke, ON M9W 5Z9
	(416) 675-5511 www.ckc.ca
CKC Director	Mr. Richard Paquette
Lure Coursing Rep	Eva Hunter

Exhibitors Please Note: It shall be the duty and obligation of the event-giving club to see that a judge, club official, volunteer, or any participant at an event held under these rules is not subject to any indignities of any kind. The Event Committee Chair shall promptly report to the CKC any infringement of this regulation, and the Discipline Committee shall have the authority to take such action as it deems fit on receipt of a report indicating that this has occurred.

ENTRIES

Entry fee for Regular classes.....	\$20.00
Listing fee	\$ 9.50*

*A listing fee of \$9.50 must accompany each entry for each dog per show and is payable with the entry fee if the entry form for the dog does not include its CKC individual registration number.

Mail entries to:

Janice Preiss, 332 Centre St. N., Beeton, ON LOG 1A0
Make cheques payable to "Saluki Club of Canada." Credit cards or postdated cheques will not be accepted.



Enter via The Entry Line:

1-800-293-2935 | Fax: (519) 754-0796 | www.theentryline.com
Mastercard Visa American Express

ENTRIES TAKEN UNTIL 4 P.M. ON THE DAY OF CLOSING.

This is a privately owned business that charges a fee for their service.

***Entries will be acknowledged by e-mail if a legible e-mail address is provided.
No other acknowledgements will be sent.***

ENTRY INFORMATION:

1. No entry will be accepted unless all particulars called for on the entry form are completed in full and accompanied by a signed waiver and entry fees. Telephone entries cannot be accepted.
2. Cheques dated after the close of entries will not be accepted. Tendering of an NSF cheque will be considered non-payment of entry fees and can result in the cancellation of awards. All NSF/returned cheques will be assessed a \$30 service charge. There will be no refund of overpayments or duplicate entries.
3. An exhibitor has the right to withdraw an entry up to the closing date and time as published in the premium list. Written or electronic notification must be received by the Event Secretary by the official closing date and time. If written notification is not received by that time, the dog will remain entered in the event. Entries that are cancelled before the closing date will be refunded.

GENERAL INFORMATION

1. The Trial Superintendent will be in full charge of the trial, which will be governed by CKC rules.
2. If, because of riot, civil disturbance, or other acts beyond the control of management, it is impossible to open or complete the trials, no refund of Entry Fees will be made.

THERE WILL BE A LIMIT OF 75 ENTRIES ACCEPTED PER DAY.

SALUKI CLUB OF CANADA WAIVER

RELEASE OF LIABILITY, WAIVER OF CLAIMS, ASSUMPTION OF RISK AND INDEMNITY AGREEMENT



By signing this document you will waive certain legal rights, including the right to sue or claim compensation following an accident. Please read this document carefully.

I _____ [print name] certify that I am the actual owner of this/these dog(s) _____ [print name of dog(s)] or that I am the duly authorized agent of the actual owner whose name I have entered above.

In consideration of acceptance of the entry and the opportunity to have the dog judged and to win ribbons or prizes at the Chase Ability events to be held on July 30 & 31, 2016, I agree:

1. To hold the Saluki club of Canada including its members, directors, officers and employees (collectively defined as the "SCOC"), as well as the owner and lessor of the real property on which the event is held, harmless from any claim for loss or injury which may be alleged to have been caused directly or indirectly to any person or thing by the act of myself or my dog(s) while in or about the event premises or grounds near the entrance thereto and I assume all responsibility and liability for any such claim;
2. To hold the SCOC harmless from any claim for loss of this dog by disappearance, theft, death or otherwise and from any claim for damage or injury, even if such loss or damage/injury was caused or alleged to be caused by negligence of the SCOC or any other person(s);
3. To assume the sole responsibility for and agree to indemnify, defend and save the SCOC harmless from any and all loss and expense, including legal fees, by reason of the liability imposed by law upon the SCOC for damage because of bodily injuries, including death at any time resulting therefrom, sustained by any person(s), including myself, or on account of damage to property, arising out of or in consequence of my participation in the event, however such injuries, death or property damage may be caused and whether or not the same may have been caused or may be alleged to have been caused by the negligence of the SCOC or any other person(s);
4. That any cause of action, controversy or claim arising out of or related to the attendance at the event between the SCOC and myself or as to the construction, interpretation and effect of this waiver shall be settled by arbitration in the province of Ontario and
5. That the SCOC has the right to refuse this entry for cause, which the SCOC will deem sufficient.

Signature

Date

THIS WAIVER MUST ACCOMPANY YOUR ENTRIES OR THEY WILL NOT BE ACCEPTED.



OFFICIAL CANADIAN KENNEL CLUB FORM

CHASE ABILITY SALUKI CLUB OF CANADA

SATURDAY, JULY 30 and SUNDAY, JULY 31, 2016

PLEASE NOTE: THE WAIVER IN THIS PREMIUM LIST MUST ACCOMPANY YOUR ENTRIES OR THEY WILL NOT BE ACCEPTED.

ENTRY FEES \$ _____ LISTING FEES \$ _____ TOTAL \$ _____

DATES:

Saturday, July 30, 2016

Sunday, July 31, 2016

CLASSES:

Dogs 12" and Shorter and/or Brachycephalic Dogs

Dogs Over 12"

Reg. Name of Dog _____

Call Name _____ Breed _____ Male Female

CKC Reg. No. _____ Date of Birth _____

CKC ERN/PEN No. _____ D _____ M _____ Y _____

CKC Misc. Cert. No. _____

CKCCCN No. _____ Place of Birth _____

Listed Canada Elsewhere

Breeder(s) _____

Sire _____

Dam _____

Reg'd Owner(s) _____ CKC Member No. _____

Owner's Address _____

City _____ Prov. _____ Postal Code _____

Name of Agent (if any) _____ Mail ID to: Owner or Agent

Agent's Address _____

City _____ Prov. _____ Postal Code _____

I CERTIFY that I am the registered owner(s) of the dog or that I am the authorized agent of the owner(s) whose name(s) I have entered above and accept full responsibility for all statements made in this entry. In consideration of the acceptance of this entry, I (we) agree to be bound by the rules and regulations of the Canadian Kennel Club and by any additional rules and regulations appearing in the premium list.

SIGNATURE OF OWNER OR AGENT

EMAIL ADDRESS

CANADIAN KENNEL CLUB INFORMATION

NON-MEMBER PARTICIPATION FEE

Effective January 1, 2011:

- A non-member participation fee will be charged to a resident of Canada who is a non-member of the CKC. The fee will be \$59.40, plus applicable taxes.
- The non-member participation fee is paid in any year a title is earned and covers all titles and dogs owned by that individual.
- In order for the title to be awarded, the non-member will have a choice to either become a CKC member or pay the non-member participation fee. Failure to comply within 30 days of notification will result in the title being withheld and the dog cannot be moved up to the next level.
- The fee applies only to dogs wholly owned by non-member residents of Canada and is not applicable to CKC members.

EVENT REGISTRATION NUMBER (ERN)

Effective January 1, 1992, all dogs that are foreign born and foreign owned and enter Canada for the sole purpose of entering CKC events will no longer require a CKC registration number but will require an Event Registration Number (ERN). This ERN does not register a dog for breeding purposes as defined in the Animal Pedigree Act, but rather enables a foreign-owned dog to be awarded titles by the Canadian Kennel Club. Each dog must have its own number.

To obtain an ERN, mail or fax a photocopy of the dog's foreign registration certificate with a cheque or VISA/MasterCard number (expiry date, cardholder's name and signature). Provide your complete address for return of the ERN to you. Cost is \$59.40, plus taxes.

AN ERN MUST BE APPLIED FOR WITHIN 30 DAYS OF FIRST DAY OF ENTERING A CKC EVENT TO AVOID CANCELLATION OF AWARDS.

MIXED AND UNRECOGNIZED BREEDS

These events are open to mixed and unrecognized breeds. In order to compete, mixed and unrecognized breed dogs must have a Canine Companion Number (CCN) from the Canadian Kennel Club and must have a CKC-approved microchip. Mixed-breed dogs must be spayed or neutered. Unrecognized-breed dogs do not need to be spayed or neutered. A dog eligible for a CCN may not be entered as a listed dog.

Event rulebooks and application forms for the CCN, ERN and Non-Member Participation Fee are available on the CKC website. For more information, contact:

THE CANADIAN KENNEL CLUB

Phone: (416) 675-5511 | Fax: (416) 675-6506
Email: information@ckc.ca | Website: www.ckc.ca
Hours: 9 a.m. to 5 p.m. (Monday - Friday)

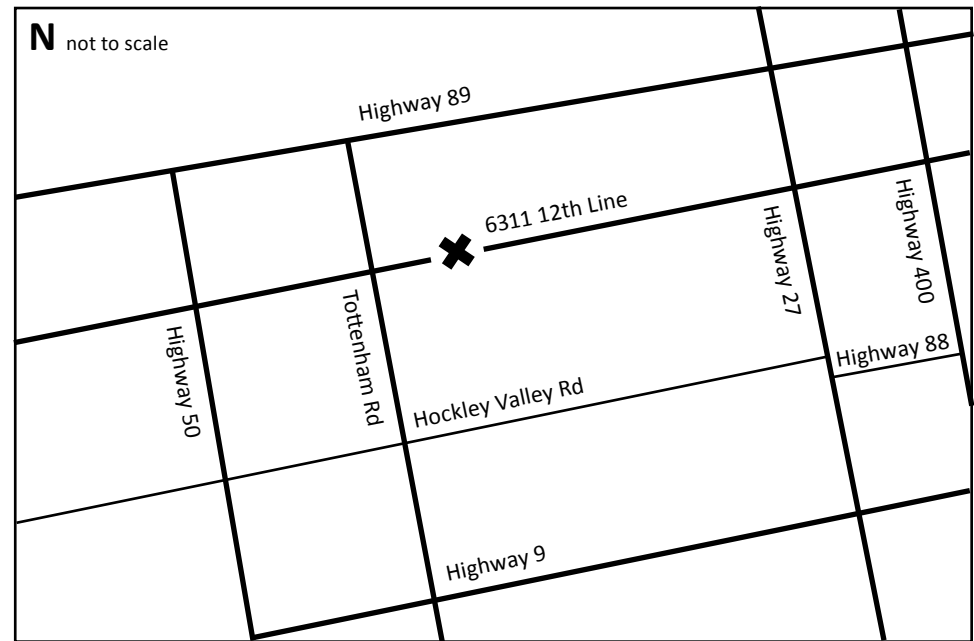

DIRECTIONS FROM HWY 400: Exit 64 at Hwy 88. Go West towards Bond Head. Turn right on Hwy 27. Left on Simcoe Country Rd. #1 towards Beeton; the first traffic light is Patterson St. Turn right on Patterson; go north to the 12th Line. Turn left (west) on the #6311 is on the left.

ADDITIONAL INFORMATION

- Port-a-potty on site.
- Dogs will be run once.
- Lame dogs or bitches in season will be excused and their entry refunded, provided notice is given prior to or during roll call.
- Dogs not present at roll call shall be scratched with no refunds. No Exceptions.
- Dogs are expected to be aroused and excited in the presence of the lure, but handlers must be able to control their dogs for everyone's safety or they shall be refunded their entry and not allowed to run. Additionally, the field committee reserves the right to bar known aggressive dogs from the event site.
- Muzzles and catch collars may be used at the handler's discretion. **No Flexi-leads, or prong or electronic collars allowed.**
- A \$10 fine will be assessed for loose dogs on the field after roll call and until after the last test.
- Bring your own water and shade.
- Please clean up after yourselves and your dogs. Do not stuff plastic bags down holes. Please use the trash receptacles provided.