



Summer Classic

Aug 4 – Aug 7, 2017

at



JUDGING SCHEDULE SIX ALL-BREED AGILITY TRIALS

Aug 4th- Aug 7th, 2017

Permission has been granted by the Canadian Kennel Club for the holding of this event under CKC rules & regulations

***** 4 DAYS OF CKC AGILITY! *****



2 Rings - Ring size is 100' X 100" Ring Surface is Grass

Show Precincts for the Summer Classic Show – North American Ring, All Alberta Ring, K-Barn, Lots 7 & 8 only, Lots 10 & 11 only; Handicap R.V. parking between A & B Barns; the area surrounding the horse wash bays. No connection roads and/or pathways are included.

Post Closing Entries will be accepted space permitting!

Judges

Danielle Levangie

Sherri L Gourlie

Trials 1, 2 and 5

Trials 3, 4 and 6

To be held outdoors, rain or shine

Here's What's Happening over the Weekend

Reserved Benching:

All Alberta Ring Outdoor Benching:

- Outdoor benching commences at **2:00 pm** on Thursday, Aug 3th.
- Grass mats or tents with floors **are not** permitted in the day tenting areas of the North American or All-Alberta Fields. This WILL be strictly enforced!!!
- **You are responsible for leaving your space as you found it.... CLEAN! Please ensure that you have a rake/tool handy to clean up your area, left behind garbage, dog hair, rubber bands, etc. is not the responsibility of the Alberta Kennel Club Volunteers or Spruce Meadows Personnel to clean up after you. We thank you for your cooperation in this regard!**
- You are welcome to drive into the designated Pick-up / Drop-off area on the north side of the All Alberta Field. This area will be in operation on Thursday from 2pm onward and following Best in Show on Monday. Note that you only have 15 minutes to drop off/pick up.
- Once you have dropped off your items, please make your way to Lot 7 for parking.
- Please note there is no parking off of Tournament Lane or in the driveway next to the Chinook Ring, vehicles parked in this area will be towed.
- There is no parking permitted between the North American Ring or the All Alberta Ring, vehicles parked in this area will be towed.
- NO PRIVATE GOLF CARTS ON EITHER FIELD AT ANY TIME.
- There is also no overnight stays anywhere but in the assigned RV areas; these are Lot 7, 10, 11 and handicapped
- Unreserved Benching areas are available in designated areas only.

THURSDAY, AUGUST 3rd, 2017

AGILITY RING PRACTICE TIME

\$10 for 5 minutes of time in the ring.

No judge - A frame will be set at small dog height for duration of Practice Time

Ringside Registration: 5:30 – 7:00 p.m.

CASH ONLY

Practice Time Begins at 6:00 p.m.

Wristbands:

- Starting on Thursday, Aug 3th from 3:00 PM onwards, come to the AKC Show Secretary desk located on the south side of the North American Field (by the North American Viewing Building) for pick-up. Wrist bands will be available for pick up Friday through Monday at the Agility Show Secretary table for Agility competitors. For those folks RV'ing with us, the wrist bands will be handed out during check in. These will allow you to come and go through the gates throughout the weekend.

Agility Check in & Prepaid Catalogues:

- Check in at the Agility Show Secretary Table approximately 1 hour prior to the start of trial each day
- Pre-ordered catalogues will be available for pick up at the AKC Agility desk, Friday, Aug 4th, no sooner than 1 hr prior to start of judging & whenever the desk is open. Limited quantities available.

Equipment and course familiarization:

- Electronic Timers will be used.
- Rubberized Contacts
- There will be NO contact equipment familiarization.
- A warm – up area with a single practice jump will be provided for dogs entered in the trials.
- Handlers in all classes are permitted to walk the course, without a dog, prior to the start of the class

NEW THIS YEAR – PARKING PASSES

- All Exhibitors and Vendors will be required to display a parking pass to park ANYWHERE on the Spruce Meadows Grounds – failure to display this pass will result in having to pay the \$5/day Spectator Parking Fee.
- One Parking Pass per Entry.
- Please respect the Alberta Kennel Club and do not share this parking pass with people who are not entered in the show. We charge a spectator fee to try and keep entry costs down. Thank you for your co-operation.

Move Ups allowed one hour prior to commencement of the trial being entered. There are NO same day move ups.

We will try to accommodate those dogs with conflicts in conformation/obedience/rally, but we cannot hold the rings.

Entries will be accepted after the pre-entry deadline with the following conditions:

- There will be no discount packages allowed; the price of each run will be \$27.00.
- Entry must be received by 1 hour prior to the scheduled start of the trial being entered.
- Additional classes added after per-entry closing to an existing entry will be processed at the exhibitor's previous discount, no further discounts will be applied.

RV Parking:

RV Parking commences at 9 am on Thursday, Aug 3rd

- Parking is assigned as you arrive, if you wish to camp together, please arrive together.
- Our parking attendants will issue you your wristbands ****Please note the gate leading into Lot 10 is closed every evening at 10 pm, there are alternate ways to come and go from the RV lots. ****
- **All Motorhomes and Trailers must have boards placed under the tires that park in Lot 10 (grass).**
- **Motorhome generators must be vented up (no matter the lot)**
- If you have prepaid for a spot in our Handicapped area your trailer and tow vehicle or motorhome must be 32' or less to park in this area as per our premium list and online verbiage, you must provide a **valid, government issued handicapped placard** if you do not have one of these we will have to assign you a space in Lot 10 or 11.
- Complimentary Showers donated by the Alberta Kennel Club are available – ask at the AKC desk for directions or follow the signs – the showers are East of the Fountain “Dog Spa”. Donations are greatly appreciated ☺
- Dumping & Filling: We do not have this service available.
- All parking is a privilege at Spruce Meadows. Anyone abusing these privileges will be excused immediately from the show, and all future shows on this venue by the parking authorities and/or show superintendent.
- There is no overnight tenting permitted at Spruce Meadows.
- There are no overnight stays anywhere but in the assigned RV areas, these are Lot 10, 11 and handicapped only. No RV's or overnight camping in Lot 7 or 8.
- No open fires permitted at any time, this includes propane fire pits.
- Quiet Time is from **11:00 pm to 6:00 am** – NO GENERATORS may run during this time – **NO EXCEPTIONS!** Please be courteous to your neighbours.

Shuttle Services:

We offer complimentary shuttle services daily from 7 am to 5 pm; this service is provided by our local Rotarians. Shuttles will be rotating constantly throughout the day. Shuttles will pick-up/drop off in Lot 10, Lot 11, Paved areas and from Lot 7. Dogs, equipment and humans welcome ☺

Concessions:

- The Time Faults Pub is open at 7 am to 11 am daily for breakfast, and open the rest of the day until 9 pm for lunch or dinner. (Friday to Monday)
- There are concession stands on the East end of the horse wash bays as well as the SE entrance of the North American Field. (Friday to Monday)

“NO PARKING” RESTRICTIONS WILL BE ENFORCED. NO EXCEPTION



Check us out!

- daily results for Shows & Trials
- premium lists & judging schedules
- matches, seminars, health clinics
- breeder and club listings
- dog-related businesses and services
- all listings are free!

Canuck Dogs
www.canuckdogs.com
Your online resource for dog shows and events

Address: 18011 Spruce Meadows Way SW
Calgary, Alberta T2J 5G5

Directions to Spruce Meadows:

- **Downtown Calgary via MacLeod Trail:**
 - South on MacLeod Trail, then turn west on Spruce Meadows Trail (also known as Hwy 22X/Stoney Trail) and travel approximately 2 km, watch for signs to Tournament Lane (turn left here), then follow the signs to AKC RV Parking, North American Entrance or Lot 7.
- **From Edmonton via Deerfoot Trail:**
 - South on Deerfoot Trail, then turn west on Spruce Meadows Trail (also known as Hwy 22X/Stoney Trail) and travel approximately 2 km, watch for signs to Tournament Lane (turn left here), then follow the signs to AKC RV Parking, North American Entrance or Lot 7.
- **From US Border via Highway 2:**
 - Before reaching the southern city limits of Calgary, turn west on Spruce Meadows Trail (also known as Hwy 22x/Stoney Trail) and travel approximately 2 km, watch for signs to Tournament Lane (turn left here), then follow the signs to AKC RV Parking Lot 10, North American Entrance or Lot 7.
- Directions are also available at: albertakennelclub.org, canuckdogs.com and TheDogShow.ca. You will see a map to help you find Spruce Meadows and a map of the Spruce Meadows Facility. Enter using the west entry, Tournament Lane. Follow the signs and look for a parking assistant to direct you.
- Upon Arrival ---please follow the signs to the exhibitors drop off area and parking areas.
- Show Site Maps will be available on a limited basis at the Information Booth, they are also located in PDF form on Canuck Dogs should you wish to print them off prior to coming to the show.

Recycle, Garbage & Dog Poop:

- You are **TOTALLY** responsible for picking up after your dog. Spruce Meadows and the Alberta Kennel Club have **ZERO** tolerance for dog droppings on the grounds. Let's be responsible and set a great example keeping the grounds pristine. Exhibitors who are found not picking up after themselves will be asked to leave the show immediately, no refunds provided.
- All Exhibitors are responsible for putting their recyclables, garbage and hair in the large garbage bins.

Other Notables:

- Please enjoy a cup of coffee in the morning on the Alberta Kennel Club, coffee available on the North American Ring in the Hospitality Gazebo ☺
- SPRUCE MEADOWS IS DESIGNATED AS A NON-SMOKING AREA TO KEEP EVERYONE SAFE.
- ANIMALS LEFT IN VEHICLES will be monitored. If animals are in distress due to heat or any other circumstance, the vehicle will be forcibly entered, the animal recovered and the owner will be subject to penalty under the Animal Protection Act 2(1) (1.1) 2.1©
- Security is on site from 6 p.m. to 6 a.m. daily.

Exhibitors please note:

- Exhibitors and handlers are solely responsible for having their dogs at ringside at the scheduled time (absent dogs must be allowed for). It is not the responsibility of the Alberta Kennel Club or the ring steward to locate dogs.
- Judges shall not wait for any dog holding up a class.
- Exhibitors noting possible dog conflicts between Agility and Conformation, Obedience or Rally must notify the gate steward or agility chairperson (Marnie Harrison) before the start of judging of the class they are in. We will do our best to accommodate any conflicts, but we will not hold any classes.
- The Alberta Kennel Club will not be responsible for the loss or injury to any dog, or for the possessions of any exhibitor whether a result of accident or any other cause. It is expressly understood that every dog at this show is in the care, custody, and control of the owner or handler during the entire time the dog is on the show premises. The welfare of an exhibitor's child is the responsibility of the exhibitor. It should be understood that exhibitors will exercise control and restraint over their children.
- **Keep in mind that due to day of entries and move ups that this schedule may change slightly – please keep that in mind when planning your day and check in with the gate stewards well in advance. Thank you.**

The Alberta Kennel Club sincerely appreciates your support of our shows.

We wish you a successful show, and hope you enjoy your stay with us;

We look forward to seeing you in the future.



Alberta Kennel Club Agility Trial

Judging Schedule

Aug 4 - 7, 2017 at Spruce Meadows

Friday Aug 4			
Walk Through & Briefing at 8:45am - 1st Dog to start at 9am.			
		# of Runs	Ring #
Novice PAD 1A	D Levangie	14	1
Intermediate PAD 1A	D Levangie	10	1
Excellent PAD1A	D Levangie	13	1
Steeplechase 1	D Levangie	13	2
Excellent PAD 1B	D Levangie	11	1
Intermediate PAD 1B	D Levangie	9	1
Novice PAD 1B	D Levangie	8	1

Saturday Aug 5			
Walk Through at 8:45am - 1st Dog to start at 9:00am.			
		# of Runs	Ring #
Novice Standard 3	S Gourlie	10	1
Intermediate Standard 3	S Gourlie	5	1
Excellent Standard 3	S Gourlie	19	1
Excellent Standard 2	D Levangie	18	1
Intermediate Standard 2	D Levangie	5	1
Novice Standard 2	D Levangie	10	1

Sunday Aug 6			
Walk Through & briefing at 8:00am -1st Dog to start at 8:15 am.			
		# of Runs	Ring #
Novice Standard 4A	S Gourlie	17	1
Intermediate Standard 4A	S Gourlie	8	1
Excellent Standard 4A	S Gourlie	26	1
Excellent Standard 5	D Levangie	7	1
Intermediate Standard 5	D Levangie	6	1
Novice Standard 5	D Levangie	19	1
Novice Standard 4B	S Gourlie	12	1
Intermediate Standard 4B	S Gourlie	7	1
Excellent Standard 4B	S Gourlie	21	1

Monday Aug 7			
Walk Through & briefing at 8:00am -1st Dog to start at 8:15 am.			
		# of Runs	Ring #
Steeplechase 6	S Gourlie	11	2
Novice PAD 6A	S Gourlie	10	1
Intermediate PAD 6A	S Gourlie	2	1
Excellent PAD 6A	S Gourlie	10	1
Novice JWW 6	S Gourlie	13	2
Intermediate JWW 6	S Gourlie	6	2
Excellent JWW 6	S Gourlie	3	2

Friday Aug 4			
Walk through following Novice PAD 1B			
		# of Runs	Ring #
Jumps and Tunnels	D Levangie	53	2
Novice Standard 1	D Levangie	21	1
Intermediate Standard	D Levangie	7	1
Excellent Standard 1	D Levangie	21	1

Saturday Aug 5			
Walk Through & briefing at 8:00am -1st Dog to start at 8:15 am.			
		# of Runs	Ring #
Excellent JWW 2A	D Levangie	22	2
Intermediate JWW 2A	D Levangie	9	2
Novice JWW 2A	D Levangie	13	2
Novice JWW 3	S Gourlie	6	2
Intermediate JWW 3	S Gourlie	9	2
Excellent JWW 3	S Gourlie	21	2
Excellent JWW 2B	D Levangie	22	2
Intermediate JWW 2B	D Levangie	7	2
Novice JWW 2B	D Levangie	6	2

Sunday Aug 6			
Walk Through at 8:45am - 1st Dog to start at 9:00am.			
		# of Runs	Ring #
Excellent JWW 5	D Levangie	19	2
Intermediate JWW 5	D Levangie	10	2
Novice JWW 5	D Levangie	9	2
Novice JWW 4	S Gourlie	15	2
Intermediate JWW 4	S Gourlie	8	2
Excellent JWW 4	S Gourlie	23	2

Monday Aug 7			
Walk Through immediately following Excellent JWW 6			
		# of Runs	Ring #
Excellent PAD 6B	S Gourlie	9	1
Intermediate PAD 6B	S Gourlie	1	1
Novice PAD 6B	S Gourlie	5	1
Jumps and Tunnels 6	S Gourlie	43	2

NO TRESPASSING AREA

The area adjacent to Hwy 22X running east and west and north of the access road in the RV parking area (Lot 10) is totally out of bounds for parking, walking and exercising your dogs this summer. There will be road construction in the area. Spruce Meadows Security and the Alberta Kennel Club will have zero tolerance for infractions of the access ban. Violators of this ban will be excused from the show and the grounds and a fine will be assessed.

Please see following map for information.

Site Map
AKC - Summer Classic 2017
Entrance off Hwy 22X/Stoney Trail to Tournament Lane

N



Restricted Area
No vehicles, People or Dogs or any other animals at anytime
Trespassing Fines Levied for Violators

Entrance to Lot 10 & 11
RV Parking

RV Parking
Lot 10

RV Parking
Lot 11

RV Parking
Lot 10 (Group)

Concession & Pancake Breakfast

Sorry No Parking

Complimentary Showers
Open 24 Hours
Donations Welcome

4 Dog Wash Stations

Fountain "Dog Spa"

Drop off & Pick Up Zone
15 Minute Maximum

Unreserved Benching
Grass Area
"K" Barn
Prepaid Benching

North American Ring
Specialties & Conformation

RV Handicapped Parking
Between "A & B" Barn

Garden Court

Rotarian Shuttle Service
to Rings
8 am to 5 pm Friday to Sunday
8 am to 3 pm Monday

All Alberta Ring
Agility,
Obedience & Rally-O

The "Pub" Concession
& ATM machine

Lot 7
Exhibitor Parking
Public Parking here
and across Tournament Lane
No RV Day or Overnight Parking

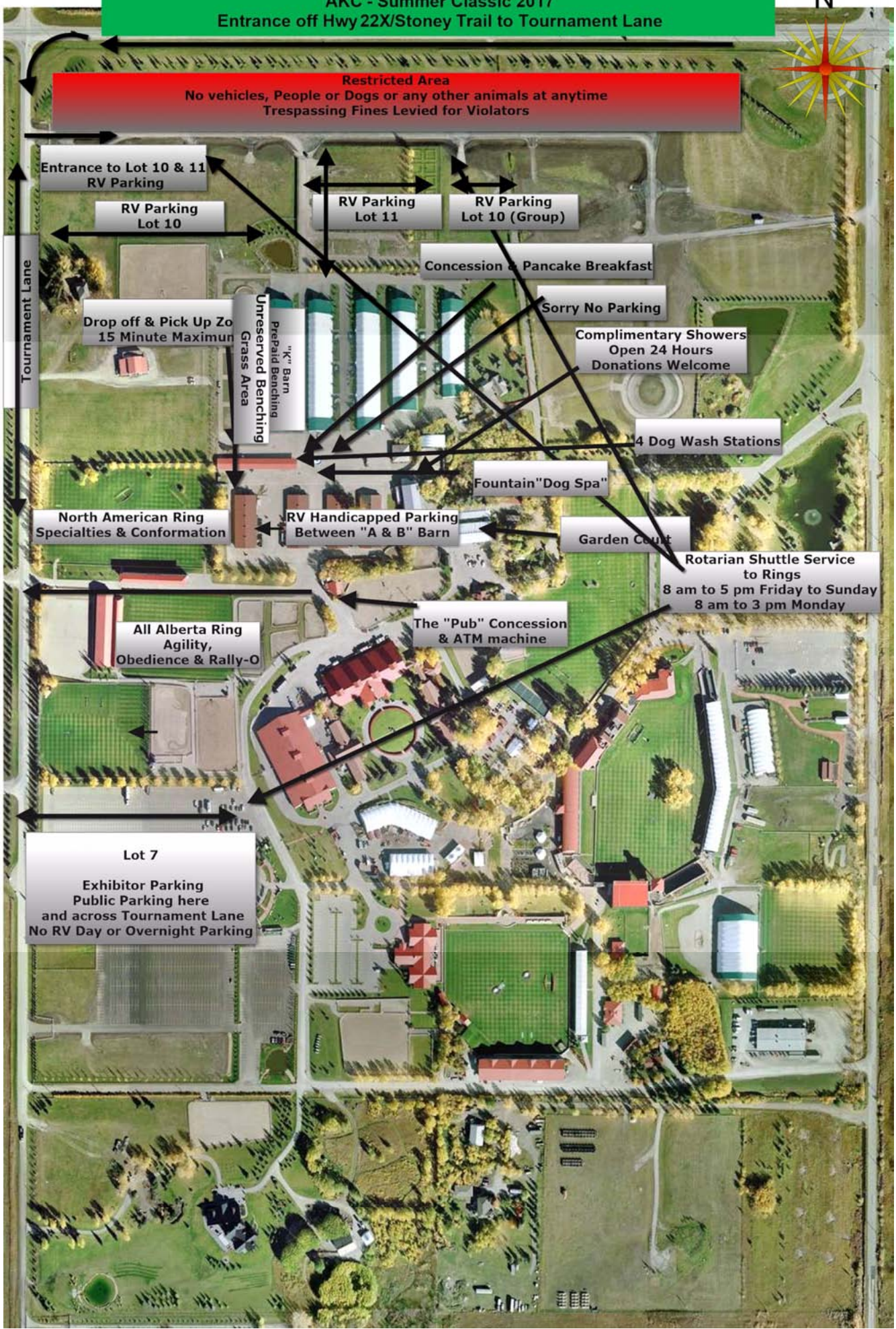

Exhibitor



Parking Pass
