

## Camping

There is a full hook up campground in Okotoks. Local campgrounds are subject to flooding so early reservations are recommended and be prepared to make alternate arrangements. Call the town offices to obtain information.

**On site** Portable washrooms will be available. Please park where directed.

## Directions

From Calgary – South on the #2 Highway, exit at the Okotoks overpass.  
Proceed south through the town of Okotoks to the intersection of #2A and #7 Highways.  
(There will be a Sobeys on your left at the intersection.)  
Turn right (West) on to #7 highway, continue past the Big Rock.  
Next left (South) past Big Rock – 64<sup>th</sup> Street. Proceed south on 64<sup>th</sup> Street to 455 Avenue.  
Turn left (East) on 455 Avenue and watch for signs.

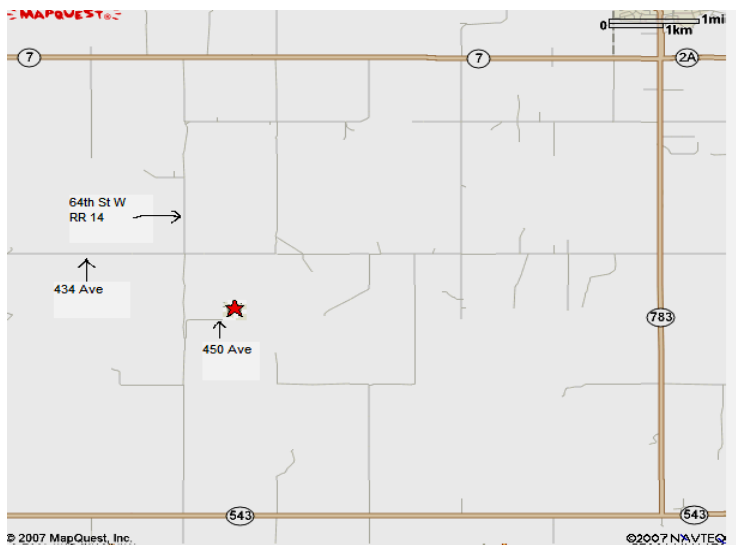
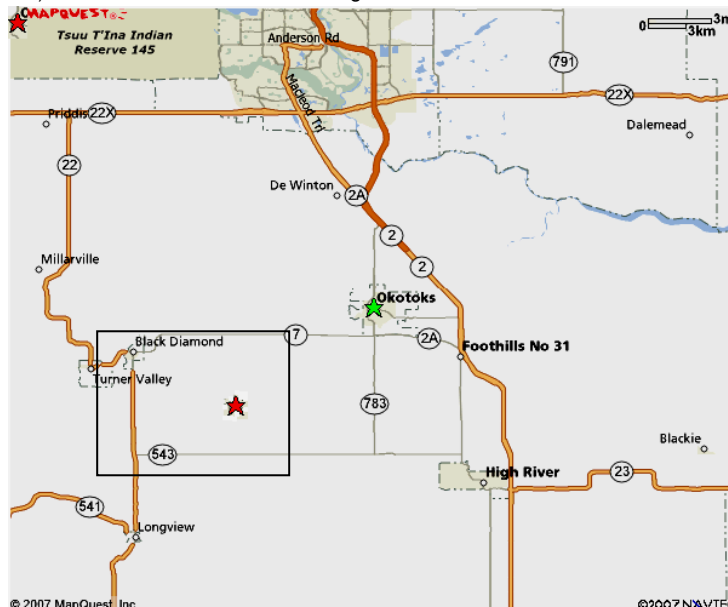

## OFFICIAL PREMIUM LIST

# PEAA



Performance and Earthdog Association of Alberta

CKC Earthdog Tests  
Limited Entry

July 18 & 19, 2015

48120 450 Avenue W  
Okotoks, Alberta

Outdoors Rain or Shine

4 Introduction to Quarry  
4 Junior Earthdog Tests  
4 Senior Earthdog Tests  
4 Master Earthdog Tests

These events held under the rules of the Canadian Kennel Club  
(unbenched) (unexamined)

# Performance and Earthdog Association of Alberta

## Officers of the Club

**President:** Mary Smithdorf  
**Vice President:** Kathy McAra  
**Secretary:** Angela Roper  
**Treasurer:** Christine Duncan  
**Director:** Megan McGovern

## Test Secretary

(to whom ALL entries must be sent)

Christine Duncan  
214 Douglasdale Court SE  
Calgary, Alberta T2Z 3B4  
Tel: (403) 236-0640 Fax: 1-877-99-Entry (36879)  
Email: peaasecretary@gmail.com

**Test Superintendent:** Mary Smithdorf  
**Earth Dog Test Committee:** Executive of the Performance and Earthdog Association of Alberta

## CKC Officers

Canadian Kennel Club: Lance Novak, CEO  
200 Ronson Drive, Suite # 400  
Etobicoke, Ont. M9W 5Z9

CKC Director: Sharon Derrick  
60 Riverview Cl SE  
Calgary, Alberta T2C 4C4

Earthdog Zone Rep: Mary Smithdorf  
Box 14, Site 1, RR #1  
Okotoks, AB T1S 1A1

## Test Judges

David Loring Brown 18545 Melrose Ridge Dr  
Wildwood, MO 63038 USA

Kathy McAra 127 Berkshire Close NW  
Calgary, AB T3K 1Z2

## GENERAL INFORMATION AND TEST RULES

**ELIGIBILITY:** This test is open to all purebred Dachshunds and those CKC recognized Terriers in Group IV and the Miscellaneous Class list originally bred for or developed for use as Earthdogs, small enough to fit into a 9 inch drain, as listed in Appendix A of the CKC Earthdog Test Rules & Regulations. Dogs must be aged 6 months or older.

**ENTRY FEES:** per dog per test

<b>Advance Entry Fees if received prior to 9:00 PM, July 8, 2015:</b>		
<b>Class</b>	<b>Single Entry Fee</b>	<b>"Package" Fee (same dog)</b>
IQ	\$15	4 runs - \$50
JE, SE, ME	\$20	4 runs - \$70
CKC ME titled dogs	\$15	4 runs - \$50

<b>Entry Fees if received after 9:00 PM, July 8, 2015 and prior to 9:00 PM, July 16, 2015:</b>		
<b>Class</b>	<b>Single Entry Fee</b>	<b>"Package" Fee (same dog)</b>
IQ	\$20	4 runs - \$70
JE, SE, ME	\$25	4 runs - \$90
CKC ME titled dogs	\$20	4 runs - \$70

<b>Entry Fees if received after 9:00 PM, July 16, 2015 and Gate Entry fees:</b>		
<b>Class</b>	<b>Single Entry Fee</b>	<b>"Package" Fee (same dog)</b>
IQ	\$20	N/A
JE, SE, ME	\$25	N/A
CKC ME titled dogs	\$20	N/A

**Listing Fees per entry:** if non CKC Indiv Reg's/ERN or PEN number ..... \$8.85

Mail entries may be sent to the Test Secretary, please provide an email address for confirmation of entry. **Online entries close at 9:00 pm July 16, 2015.**

Entry fees as listed above must accompany the entry. Make all cheques payable to:

**Performance and Earthdog Association of Alberta (PEAA)**



**ENTER ONLINE**



**www.DogShow.ca**

TOLL FREE FAX:  
**1-877-99-ENTRY (36879)**

A service charge of 10% will be assessed. This includes entries sent online, by fax or post using a credit card for payment

## GENERAL INFORMATION AND TEST RULES (Cont'd)

**ENTRIES:** Entries must be complete, signed and submitted on the official CKC entry form. The order of competing shall be the order that entries are received.

### SAME DAY MOVE UPS WILL BE ALLOWED as per Rule 6.7.1

**CLOSING DATE:** *30 minutes before the scheduled start of class* or when the stated limit has been reached. Online entries close at 9:00 pm July 16, 2015. Entries will close automatically when the following limits have been reached for each test on each day: 20 Introduction to Quarry, 25 Junior, 15 Senior and 10 Master even if the official closing date and time for the entries has not arrived. Entries are accepted on a first come, first served basis. Entry fees will not be refunded after the closing date and time. If the limit is reached prior to the closing date, a list of alternates will be kept to fill any vacancies created due to early (prior to closing date) cancellations.

**CONFIRMATION OF ENTRY:** The receipt of entries will be confirmed for those providing a **return e-mail address** on their entry form.

**BITCHES IN SEASON:** Bitches in season shall not be eligible to enter the test. When a bitch comes into season after entry of the bitch has been submitted to the test secretary, a veterinarian's certificate, certifying that the bitch was in season within the 10 day period preceding the test must reach the secretary on or before the date of the test. The trial-giving club must refund the entry fee, service charge and listing fee.

**QUARRY:** The quarry used in these tests will be 2 adult gerbils.

**ATTENTION FOREIGN EXHIBITORS:** Please note that fees are due and payable in Canadian dollars. Due to fluctuating currency rates, discounted cheques will not be accepted. Personal cheques will be accepted. If you pay by personal American cheque, it must be made out for the full amount of the entry and no exchange will be refunded to the exhibitor. Do not write "Payable in Canadian Funds" or "At Par". This will not be acceptable and will not be cleared by the bank. To simplify the process, we urge you to purchase bank drafts or money orders payable in Canadian funds.

**BORDER CROSSING:** A valid rabies certificate is required to bring a dog into Canada. Government regulations require a certificate and it must be dated at least 30 days prior to entry into Canada. Canadian Food Inspection Agency regulations can be viewed at:

<http://www.inspection.gc.ca/english/anima/heasan/import/dogse.shtml>.

**EVENT REGISTRATION NUMBER (FOREIGN BORN/FOREIGN OWNED DOG):** For the purpose of entering CKC events to obtain CKC titles, individual registration is not required for foreign born, foreign owned dogs. Foreign exhibitors may apply for an ERN (Event Registration Number). This number MUST be applied for within 30 days of entering first CKC event to avoid cancellation. Exhibitors may submit a photocopy of dog's foreign Registration Certificate and the appropriate fee along with the completed application form. The form can be downloaded from <http://www.ckc.ca/forms> or is available by contacting the CKC Order Desk at 1.800.250.8040.

**AWARDS & PRIZES:** Qualifiers in IQ will receive a Ribbon. Qualifiers in JE, SE and ME will receive a Rosette. Dogs earning a new title will be awarded a Pin.

**TEST PRECINCT:** The entire field south of the buildings. Dogs waiting to be tested shall be kept at least 30.5 m (100ft) from the perimeter of the test area in a designated holding area.

**REGULATIONS:** It is the responsibility of the exhibitor to be familiar with the rules pertaining to the event in which they are competing. Copies of the CKC Earthdog Test Regulations are available from the Canadian Kennel Club. Tel: (416) 675-5511.

**CKC REGULATION 15.7:** It shall be the duty and obligation of the event giving club to see that a judge, club official, volunteer or any participant at an Earthdog Test held under these regulations, is not subject to indignities. The Earthdog Test Committee Chair shall promptly report to the CKC any infringement of this regulation, and the Discipline Committee shall have the authority to take such action as it deems fit on receipt of a report indicating that this has occurred.

**TEST SITE:** Bring water, shade and shelter for you and your dogs. These tests will be run **rain or shine**. All dogs must be under control, on a leash except during the test. Flexi leads will not be allowed within the test precinct. Remember that this is private property and we are here at the pleasure of our hosts. Clean up after yourself and your dog. Please follow the directions of our parking sheriff! As is the case with most Earthdog Tests, the ground at the site is uneven. Wear appropriate footwear.

**WAIVER:** Please complete the enclosed waiver that excludes the property owners, the Performance and Earthdog Association of Alberta, and/or any person associated with the Earthdog Test from any liability for personal injury or personal property damage and submit it with your entry.

**LUNCHES:** There will be a potluck lunch each day, please bring something to share! Restaurants are at least 15 minutes away.

## SCHEDULE FOR EACH DAY

**Morning test:** Master Earthdog class will start no earlier than 9:00 AM. Introduction to Quarry will start no earlier than 9:30 AM.

**Afternoon test:** Afternoon classes will start no earlier than 1:00 PM.

Order of classes and judging assignments follow (classes may be run concurrently):

Test I (Morning)	Test II (Afternoon)	Test III (Morning)	Test IV (Afternoon)
ME K McAra	IQ K McAra	ME D Loring Brown	IQ D Loring Brown
IQ D Loring Brown	SE D Loring Brown	IQ K McAra	SE K McAra
SE K McAra	JE K McAra	SE D Loring Brown	JE D Loring Brown
JE D Loring Brown	ME D Loring Brown	JE K McAra	ME K McAra

## CKC Non-Member Participation Fee

(This only applies to dogs wholly owned by non members and is not applicable to CKC members or dogs co-owned with a CKC member, nor does it affect US exhibitors who must apply for an ERN number as noted above)

A non-member resident in Canada is subject to the fee. Dogs co-owned with a CKC member are exempt. There are 2 options for non-members:

- a) Join the CKC, or
- b) Pay the Non-Member Participation Fee

The fee is a yearly charge based on the calendar year January 1 to December 31 in which the awards, legs, points, titles, etc. were achieved. It is not based on the number of dogs or titles or awards earned, and is assessed against the owner(s).

Non-members will receive a letter from CKC Head Office informing them that they have 30 days to join the Club or pay the Non-Member Participation Fee.

Payment of the Non-Member Participation Fee or becoming a CKC member will protect all awards, points, titles and legs in the calendar year in which they were earned. Failure to pay the fee within 30 days of the notice will result in all awards, legs, points, titles being cancelled. Once cancelled the awards, legs, points or titles will be given to the next applicable dog. Once cancellation takes place any subsequent awards titles, legs, etc. earned will automatically be cancelled without further notice.

Please note that the CKC Membership application and the Non-Member Participation Fee forms are available on the website under CKC Services and then Forms On-Line. If submitting a Membership Application, please ensure that you also complete the Non-Member Participation Fee form so that CKC is aware of the dogs involved.

## Performance and Earthdog Association of Alberta Earthdog Participation Agreement

Smithart Kennels  
Site 1 Box 14 RR 1  
48120 450 Ave W  
Okotoks, AB T1S 1A1

403.540.9186  
smithart@platinum.ca

### Waiver and Indemnity

It shall be known that:

Name \_\_\_\_\_  
(known as participant)  
spouse & minor children, if present \_\_\_\_\_  
(also known as participants)

Address \_\_\_\_\_

Town, Province/State, Postal Code/Zip Code \_\_\_\_\_

Phone \_\_\_\_\_ Email \_\_\_\_\_

Hereby desires to engage in and does engage in any or all of the following canine, or other activities provided at Smithart Kennels, 48120 450 Avenue W, Okotoks, AB, T1S 1A1, owned by Mark N. and Mary C. Smithdorf.

Earthdog Tests

As a Volunteer  As a Participant  As a Spectator  As a Camper

In consideration of the above activities, services and entry fees paid, receipt and sufficiency of which is hereby acknowledged, the Participant hereby does forever and finally release, remise, satisfy, acquit, satisfy and forever discharge Performance and Earthdog Association of Alberta, Smithart Kennels, Mark N. and Mary C. Smithdorf (including employees, teachers, trainers, and agents) of and from all manner of action and actions, cause and causes of action, suit debts, dues, sums of money, bonds, billings, contracts, controversies, agreements, promises, damages, variances, judgments, executions, claims and demands whatsoever, in the law or in equity, which may arise or might in the future arise or herein after may arise for or against Smithart Kennels, the Performance and Earthdog Association of Alberta, or the landowners for the activities as stated above.

Photo and video release. My signature below authorizes the Performance and Earthdog Association of Alberta to use images of me and my family for publication or to promote or document the events we participate in. This document is meant to be a full and complete release from any and all liability that may arise on the properties of Smithart Kennels, Mark N. and Mary C. Smithdorf and employees, jointly and severally. This release is given freely and voluntarily by the participant and is meant to remain in existence throughout the duration of my presence on the property for any period of time in association with the canine event and/or other activities whether I am or am not found to be negligent while handling or near a dog in the above mentioned activities.

Date \_\_\_\_\_ Signature of participant(s) \_\_\_\_\_

Legal Guardian (if participant is a minor child) \_\_\_\_\_

**THIS AGREEMENT MUST BE SIGNED FOR YOUR ENTRY(S) TO BE ACCEPTED**

**Dog Show**™  
ca

**ENTER OUR  
10th ANNIVERSARY CONTEST!**



**ENTER ONLINE AT [WWW.DOGSHOW.CA](http://WWW.DOGSHOW.CA)**  
**AND WIN A TRIP\* FOR TWO TO  
THE 2016 CRUFTS IN BIRMINGHAM, ENGLAND**







A service charge of 10% will be assessed. This includes entries sent online, by fax or post using a credit card for payment

\* No purchase required. Full contest details available at [www.DogShow.ca/Contest](http://www.DogShow.ca/Contest)

OFFICE USE		OFFICIAL CANADIAN KENNEL CLUB ENTRY FORM		OFFICE USE	
<b>Performance and Earthdog Association of Alberta July 18 &amp; 19, 2015</b>					
I ENCLOSE \$ _____		ENTRY FEES \$ _____			
		LISTING FEES \$ _____			
<b>PLEASE TYPE OR PRINT CLEARLY</b>					
BREED _____ Variety: _____			___ MALE ___ FEMALE		
<b>ENTER IN ONE OF THE FOLLOWING CLASSES:</b>					
Test I IQ _____ JE _____ SE _____ ME _____	Test II IQ _____ JE _____ SE _____ ME _____	Test III IQ _____ JE _____ SE _____ ME _____	Test IV IQ _____ JE _____ SE _____ ME _____	Call Name: _____	
REG. NAME OF DOG _____					
<b>CHECK ONE AND ENTER NUMBER HERE</b>			<b>DATE OF BIRTH</b>		
<input type="checkbox"/> CKC REG. NO. <input type="checkbox"/> CKC MISC. CERT. NO. <input type="checkbox"/> CKC PEN NO.			<input type="checkbox"/> CKC ERN NO. <input type="checkbox"/> LISTED		
			_____/_____/_____ Day / Month / Year		
<b>NUMBER:</b> _____			<b>PLACE OF BIRTH</b> ___ CANADA ___ ELSEWHERE		
BREEDER(S) _____					
SIRE _____					
DAM _____					
REG'D OWNER(S) _____					
OWNER'S ADDRESS _____					
CITY _____		PROV./STATE _____	POSTAL CODE _____		
NAME OF OWNER'S AGENT (IF ANY) AT THE SHOW _____					
AGENT'S ADDRESS _____					
CITY _____		PROV./STATE _____	POSTAL CODE _____		
ID'S WILL NOT BE MAILED – PLEASE SUPPLY VALID EMAIL ADDRESS BELOW FOR ENTRY CONFIRMATION					
I CERTIFY that I am the registered owner(s) of the dog or that I am the authorized agent of the owner(s) whose name(s) I have entered above and accept full responsibility for all statements made in this entry. In consideration of the acceptance of this entry, I (we) agree to be bound by the rules and regulations of the Canadian Kennel Club and by any additional rules and regulations appearing in the premium list.					
SIGNATURE OF OWNER OR AGENT _____			TELEPHONE NUMBER _____		
E-MAIL ADDRESS: _____					

OFFICE USE		OFFICIAL CANADIAN KENNEL CLUB ENTRY FORM		OFFICE USE	
<b>Performance and Earthdog Association of Alberta July 18 &amp; 19, 2015</b>					
I ENCLOSE \$ _____		ENTRY FEES \$ _____			
		LISTING FEES \$ _____			
<b>PLEASE TYPE OR PRINT CLEARLY</b>					
BREED _____ Variety: _____			___ MALE ___ FEMALE		
<b>ENTER IN ONE OF THE FOLLOWING CLASSES:</b>					
Test I IQ _____ JE _____ SE _____ ME _____	Test II IQ _____ JE _____ SE _____ ME _____	Test III IQ _____ JE _____ SE _____ ME _____	Test IV IQ _____ JE _____ SE _____ ME _____	Call Name: _____	
REG. NAME OF DOG _____					
<b>CHECK ONE AND ENTER NUMBER HERE</b>			<b>DATE OF BIRTH</b>		
<input type="checkbox"/> CKC REG. NO. <input type="checkbox"/> CKC MISC. CERT. NO. <input type="checkbox"/> CKC PEN NO.			<input type="checkbox"/> CKC ERN NO. <input type="checkbox"/> LISTED		
			_____/_____/_____ Day / Month / Year		
<b>NUMBER:</b> _____			<b>PLACE OF BIRTH</b> ___ CANADA ___ ELSEWHERE		
BREEDER(S) _____					
SIRE _____					
DAM _____					
REG'D OWNER(S) _____					
OWNER'S ADDRESS _____					
CITY _____		PROV./STATE _____	POSTAL CODE _____		
NAME OF OWNER'S AGENT (IF ANY) AT THE SHOW _____					
AGENT'S ADDRESS _____					
CITY _____		PROV./STATE _____	POSTAL CODE _____		
ID'S WILL NOT BE MAILED – PLEASE SUPPLY VALID EMAIL ADDRESS BELOW FOR ENTRY CONFIRMATION					
I CERTIFY that I am the registered owner(s) of the dog or that I am the authorized agent of the owner(s) whose name(s) I have entered above and accept full responsibility for all statements made in this entry. In consideration of the acceptance of this entry, I (we) agree to be bound by the rules and regulations of the Canadian Kennel Club and by any additional rules and regulations appearing in the premium list.					
SIGNATURE OF OWNER OR AGENT _____			TELEPHONE NUMBER _____		
E-MAIL ADDRESS: _____					